



OTO PERK

**EUR**  **DIESEL**

**Bosch Tip CR Enjektör Şimleri**

**Bosch Type CR Injector Shims**

**Perk**  
Diesel

**OTO PERK**

[www.eurodiesel.com](http://www.eurodiesel.com)

## combined handbag

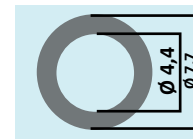
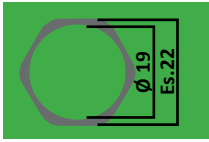
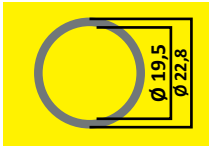
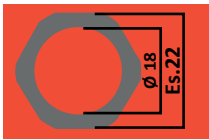

Cod PERK	Ref. code BOSCH	QTY
A1-23347	F 00R J02 760	1000



combined handbox 96 position

Dia	ref. original	cod.PERK
0,954	F 00R J00 026	A1-23288/0954
0,958	F 00R J00 028	A1-23288/0958
0,962	F 00R J00 030	A1-23288/0962
0,966	F 00R J00 032	A1-23288/0966
0,970	F 00R J00 034	A1-23288/0970
0,974	F 00R J00 036	A1-23288/0974
0,978	F 00R J00 038	A1-23288/0978
0,982	F 00R J00 040	A1-23288/0982
0,986	F 00R J00 042	A1-23288/0986
0,990	F 00R J00 044	A1-23288/0990
0,994	F 00R J00 046	A1-23288/0994
0,998	F 00R J00 048	A1-23288/0998
1,002	F 00R J00 050	A1-23288/1002
1,006	F 00R J00 052	A1-23288/1006
1,010	F 00R J00 054	A1-23288/1010
1,014	F 00R J00 056	A1-23288/1014
1,018	F 00R J00 058	A1-23288/1018
1,022	F 00R J00 060	A1-23288/1022
1,026	F 00R J00 062	A1-23288/1026
1,030	F 00R J00 064	A1-23288/1030
1,034	F 00R J00 066	A1-23288/1034
1,038	F 00R J00 068	A1-23288/1038
1,042	F 00R J00 070	A1-23288/1042
1,046	F 00R J00 072	A1-23288/1046

dia	ref. original	cod.PERK
1,005	F 00R J01 010	A1-23332/1005
1,015	F 00R J01 011	A1-23332/1015
1,025	F 00R J01 012	A1-23332/1025
1,035	F 00R J01 013	A1-23332/1035
1,045	F 00R J01 014	A1-23332/1045
1,055	F 00R J01 015	A1-23332/1055
1,065	F 00R J01 016	A1-23332/1065
1,075	F 00R J01 017	A1-23332/1075
1,085	F 00R J01 018	A1-23332/1085
1,095	F 00R J01 019	A1-23332/1095
1,105	F 00R J01 020	A1-23332/1105
1,115	F 00R J01 021	A1-23332/1115

misura	rif. original	cod.PERK
1,04	F 00R J00 192	A1-23228/104
1,06	F 00R J00 273	A1-23228/106
1,08	F 00R J00 193	A1-23228/108
1,10	F 00R J00 274	A1-23228/110
1,12	F 00R J00 194	A1-23228/112
1,14	F 00R J00 275	A1-23228/114
1,16	F 00R J00 195	A1-23228/116
1,18	F 00R J00 276	A1-23228/118
1,20	F 00R J00 196	A1-23228/120
1,22	F 00R J00 277	A1-23228/122
1,24	F 00R J00 197	A1-23228/124
1,26	F 00R J00 278	A1-23228/126

misura	rif. original	cod.PERK
1,24	F 00R J00 126	A1-23235/124
1,25	F 00R J00 128	A1-23235/125
1,26	F 00R J00 130	A1-23235/126
1,27	F 00R J00 132	A1-23235/127
1,28	F 00R J00 134	A1-23235/128
1,29	F 00R J00 136	A1-23235/129
1,30	F 00R J00 138	A1-23235/130
1,31	F 00R J00 140	A1-23235/131
1,32	F 00R J00 142	A1-23235/132
1,33	F 00R J00 144	A1-23235/133
1,34	F 00R J00 146	A1-23235/134
1,35	F 00R J00 148	A1-23235/135

dia	ref. original	cod.PERK
1,516	F 00R J00 871	A1-23287/1516
1,520	F 00R J00 873	A1-23287/1520
1,524	F 00R J00 875	A1-23287/1524
1,528	F 00R J00 877	A1-23287/1528
1,532	F 00R J00 879	A1-23287/1532
1,536	F 00R J00 881	A1-23287/1536
1,540	F 00R J00 883	A1-23287/1540
1,544	F 00R J00 885	A1-23287/1544
1,548	F 00R J00 887	A1-23287/1548
1,552	F 00R J00 889	A1-23287/1552
1,556	F 00R J00 891	A1-23287/1556
1,560	F 00R J00 893	A1-23287/1560
1,564	F 00R J00 895	A1-23287/1564
1,568	F 00R J00 897	A1-23287/1568
1,572	F 00R J00 899	A1-23287/1572
1,576	F 00R J00 901	A1-23287/1576
1,580	F 00R J00 903	A1-23287/1580
1,584	F 00R J00 905	A1-23287/1584
1,588	F 00R J00 907	A1-23287/1588
1,592	F 00R J00 909	A1-23287/1592
1,596	F 00R J00 911	A1-23287/1596
1,600	F 00R J00 913	A1-23287/1600
1,604	F 00R J00 915	A1-23287/1604
1,608	F 00R J00 917	A1-23287/1608
1,612	F 00R J00 919	A1-23287/1612
1,616	F 00R J00 921	A1-23287/1616
1,620	F 00R J00 923	A1-23287/1620
1,624	F 00R J00 925	A1-23287/1624
1,628	F 00R J00 927	A1-23287/1628
1,632	F 00R J00 929	A1-23287/1632
1,636	F 00R J00 931	A1-23287/1636
1,640	F 00R J00 933	A1-23287/1640
1,644	F 00R J00 935	A1-23287/1644
1,648	F 00R J00 937	A1-23287/1648
1,652	F 00R J00 939	A1-23287/1652
1,656	F 00R J00 941	A1-23287/1656

combined version

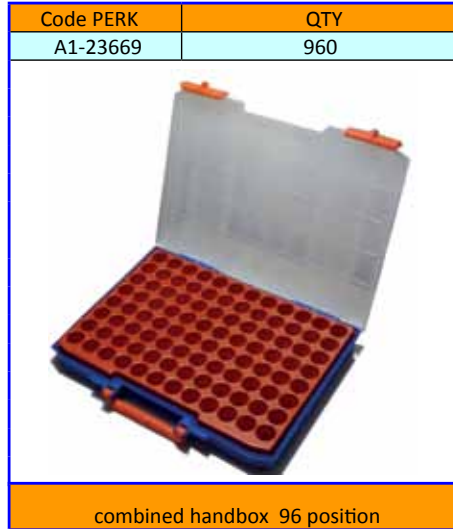
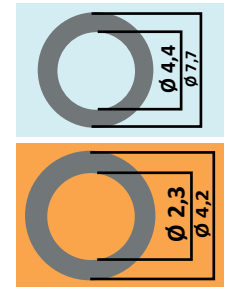
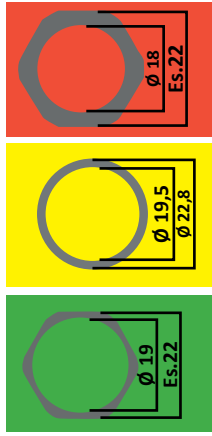

dia	cod.PERK
0,90	A1-23288/090
0,91	A1-23288/091
0,92	A1-23288/092
0,93	A1-23288/093
0,94	A1-23288/094
0,95	A1-23288/095
0,96	A1-23288/096
0,97	A1-23288/097
0,98	A1-23288/098
0,99	A1-23288/099
1,00	A1-23288/100
1,01	A1-23288/101
1,02	A1-23288/102
1,03	A1-23288/103
1,04	A1-23288/104
1,05	A1-23288/105
1,06	A1-23288/106
1,07	A1-23288/107
1,08	A1-23288/108
1,09	A1-23288/109
1,10	A1-23288/110
1,11	A1-23288/111
1,12	A1-23288/112
1,13	A1-23288/113

dia	cod.PERK
1,00	A1-23332/100
1,02	A1-23332/102
1,04	A1-23332/104
1,06	A1-23332/106
1,08	A1-23332/108
1,10	A1-23332/110
1,12	A1-23332/112
1,14	A1-23332/114
1,16	A1-23332/116
1,18	A1-23332/118
1,20	A1-23332/120
1,22	A1-23332/122

dia	cod.PERK
1,20	A1-23228/120
1,22	A1-23228/122
1,24	A1-23228/124
1,26	A1-23228/126
1,28	A1-23228/128
1,30	A1-23228/130
1,32	A1-23228/132
1,34	A1-23228/134
1,36	A1-23228/136
1,38	A1-23228/138
1,40	A1-23228/140
1,42	A1-23228/142
1,44	A1-23228/144
1,46	A1-23228/146
1,48	A1-23228/148
1,50	A1-23228/150
1,52	A1-23228/152
1,54	A1-23228/154
1,56	A1-23228/156
1,58	A1-23228/158
1,60	A1-23228/160
1,62	A1-23228/162
1,64	A1-23228/164
1,66	A1-23228/166

dia	cod.PERK
1,30	A1-23287/130
1,32	A1-23287/132
1,34	A1-23287/134
1,36	A1-23287/136
1,38	A1-23287/138
1,40	A1-23287/140
1,42	A1-23287/142
1,44	A1-23287/144
1,46	A1-23287/146
1,48	A1-23287/148
1,50	A1-23287/150
1,52	A1-23287/152
1,54	A1-23287/154
1,56	A1-23287/156
1,58	A1-23287/158
1,60	A1-23287/160
1,62	A1-23287/162
1,64	A1-23287/164
1,66	A1-23287/166
1,68	A1-23287/168
1,70	A1-23287/170
1,72	A1-23287/172
1,74	A1-23287/174
1,76	A1-23287/176

dia	cod.PERK
1,00	A1-23235/100
1,01	A1-23235/101
1,02	A1-23235/102
1,03	A1-23235/103
1,04	A1-23235/104
1,05	A1-23235/105
1,06	A1-23235/106
1,07	A1-23235/107
1,08	A1-23235/108
1,09	A1-23235/109
1,10	A1-23235/110
1,11	A1-23235/111

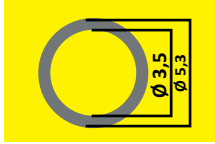
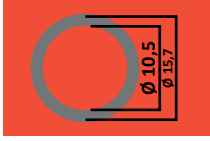

Code PERK	REF cod BOSCH	QTY
A1-23349	F 00V C99 016	960

handbox 96 position

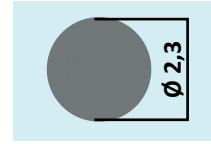

dia	ref. original	cod. PERK
1,194	F 00V C10 402	A1-23219/1194
1,198	F 00V C10 404	A1-23219/1198
1,202	F 00V C10 406	A1-23219/1202
1,206	F 00V C10 408	A1-23219/1206
1,21	F 00V C10 410	A1-23219/121
1,214	F 00V C10 412	A1-23219/1214
1,218	F 00V C10 414	A1-23219/1218
1,222	F 00V C10 416	A1-23219/1222
1,226	F 00V C10 418	A1-23219/1226
1,23	F 00V C10 420	A1-23219/123
1,234	F 00V C10 422	A1-23219/1234
1,238	F 00V C10 424	A1-23219/1238
1,242	F 00V C10 426	A1-23219/1242
1,246	F 00V C10 428	A1-23219/1246
1,25	F 00V C10 430	A1-23219/125
1,254	F 00V C10 432	A1-23219/1254
1,258	F 00V C10 434	A1-23219/1258
1,262	F 00V C10 436	A1-23219/1262
1,266	F 00V C10 438	A1-23219/1266
1,27	F 00V C10 440	A1-23219/127
1,274	F 00V C10 442	A1-23219/1274
1,278	F 00V C10 444	A1-23219/1278
1,282	F 00V C10 446	A1-23219/1282
1,286	F 00V C10 448	A1-23219/1286

dia	ref. original	ref. original	cod. PERK
1,10	F 00V C10 470	F 00V C10 580	A1-23220/110
1,12	F 00V C10 472	F 00V C10 582	A1-23220/112
1,14	F 00V C10 474	F 00V C10 584	A1-23220/114
1,16	F 00V C10 476	F 00V C10 586	A1-23220/116
1,18	F 00V C10 478	F 00V C10 588	A1-23220/118
1,20	F 00V C10 480	F 00V C10 590	A1-23220/120
1,22	F 00V C10 482	F 00V C10 592	A1-23220/122
1,24	F 00V C10 484	F 00V C10 594	A1-23220/124
1,26	F 00V C10 486	F 00V C10 596	A1-23220/126
1,28	F 00V C10 488	F 00V C10 598	A1-23220/128
1,30	F 00V C10 490	F 00V C10 600	A1-23220/130
1,32	F 00V C10 492	F 00V C10 602	A1-23220/132
1,34	F 00V C10 494	F 00V C10 604	A1-23220/134
1,36	F 00V C10 496	F 00V C10 606	A1-23220/136
1,38	F 00V C10 498	F 00V C10 608	A1-23220/138
1,40	F 00V C10 500	F 00V C10 610	A1-23220/140
1,42	F 00V C10 502	F 00V C10 612	A1-23220/142
1,44	F 00V C10 504	F 00V C10 614	A1-23220/144
1,46	F 00V C10 506	F 00V C10 616	A1-23220/146
1,48	F 00V C10 508	F 00V C10 618	A1-23220/148
1,50	F 00V C10 510	F 00V C10 620	A1-23220/150
1,52	F 00V C10 512	F 00V C10 622	A1-23220/152
1,54	F 00V C10 514	F 00V C10 624	A1-23220/154
1,56	F 00V C10 516	F 00V C10 626	A1-23220/156
1,58	F 00V C10 518	F 00V C10 628	A1-23220/158
1,60	F 00V C10 520	F 00V C10 630	A1-23220/160
1,62	F 00V C10 522	F 00V C10 632	A1-23220/162
1,64	F 00V C10 524	F 00V C10 634	A1-23220/164
1,66	F 00V C10 526	F 00V C10 636	A1-23220/166
1,68	F 00V C10 528	F 00V C10 638	A1-23220/168
1,70	F 00V C10 530	F 00V C10 640	A1-23220/170
1,72	F 00V C10 532	F 00V C10 642	A1-23220/172
1,74	F 00V C10 534	F 00V C10 644	A1-23220/174
1,76	F 00V C10 536	F 00V C10 646	A1-23220/176
1,78	F 00V C10 538	F 00V C10 648	A1-23220/178
1,80	F 00V C10 540	F 00V C10 650	A1-23220/180

dia	cod. PERK
1,02	A1-23232/102
1,03	A1-23232/103
1,04	A1-23232/104
1,05	A1-23232/105
1,06	A1-23232/106
1,07	A1-23232/107
1,08	A1-23232/108
1,09	A1-23232/109
1,10	A1-23-232/110
1,11	A1-23232/111
1,12	A1-23232/112
1,13	A1-23232/113
1,14	A1-23232/114
1,15	A1-23232/115
1,16	A1-23232/116
1,17	A1-23232/117
1,18	A1-23232/118
1,19	A1-23232/119
1,20	A1-23232/120
1,21	A1-23232/121
1,22	A1-23232/122
1,23	A1-23232/123
1,24	A1-23232/124
1,25	A1-23232/125

dia	ref. original	cod. PERK
8,409	F 00V C12 444	A1-23227/8409
8,421	F 00V C12 448	A1-23227/8421
8,433	F 00V C12 452	A1-23227/8433
8,445	F 00V C12 456	A1-23227/8445
8,457	F 00V C12 460	A1-23227/8457
8,469	F 00V C12 464	A1-23227/8469
8,481	F 00V C12 468	A1-23227/8481
8,493	F 00V C12 472	A1-23227/8493
8,505	F 00V C12 476	A1-23227/8505
8,517	F 00V C12 480	A1-23227/8517
8,529	F 00V C12 484	A1-23227/8529
8,541	F 00V C12 488	A1-23227/8541



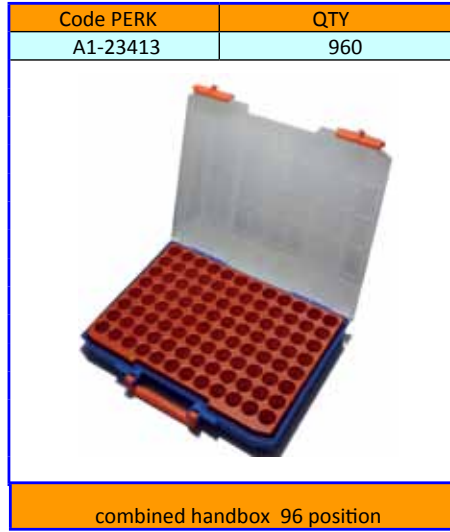
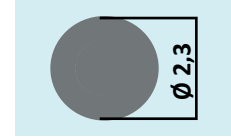
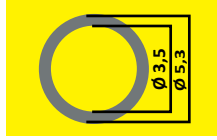

dia	cod. PERK
1,10	A1-23219/110
1,11	A1-23219/111
1,12	A1-23219/112
1,13	A1-23219/113
1,14	A1-23219/114
1,15	A1-23219/115
1,16	A1-23219/116
1,17	A1-23219/117
1,18	A1-23219/118
1,19	A1-23219/119
1,20	A1-23219/120
1,21	A1-23219/121
1,22	A1-23219/122
1,23	A1-23219/123
1,24	A1-23219/124
1,25	A1-23219/125
1,26	A1-23219/126
1,27	A1-23219/127
1,28	A1-23219/128
1,29	A1-23219/129
1,30	A1-23219/130
1,31	A1-23219-131
1,32	A1-23219-132
1,33	A1-23219/133

dia	ref original 1	ref original 2	cod PERK
1,10	F 00V C10 470	F 00V C10 580	A1-23220/110
1,12	F 00V C10 472	F 00V C10 582	A1-23220/112
1,14	F 00V C10 474	F 00V C10 584	A1-23220/114
1,16	F 00V C10 476	F 00V C10 586	A1-23220/116
1,18	F 00V C10 478	F 00V C10 588	A1-23220/118
1,20	F 00V C10 480	F 00V C10 590	A1-23220/120
1,22	F 00V C10 482	F 00V C10 592	A1-23220/122
1,24	F 00V C10 484	F 00V C10 594	A1-23220/124
1,26	F 00V C10 486	F 00V C10 596	A1-23220/126
1,28	F 00V C10 488	F 00V C10 598	A1-23220/128
1,30	F 00V C10 490	F 00V C10 600	A1-23220/130
1,32	F 00V C10 492	F 00V C10 602	A1-23220/132
1,34	F 00V C10 494	F 00V C10 604	A1-23220/134
1,36	F 00V C10 496	F 00V C10 606	A1-23220/136
1,38	F 00V C10 498	F 00V C10 608	A1-23220/138
1,40	F 00V C10 500	F 00V C10 610	A1-23220/140
1,42	F 00V C10 502	F 00V C10 612	A1-23220/142
1,44	F 00V C10 504	F 00V C10 614	A1-23220/144
1,46	F 00V C10 506	F 00V C10 616	A1-23220/146
1,48	F 00V C10 508	F 00V C10 618	A1-23220/148
1,50	F 00V C10 510	F 00V C10 620	A1-23220/150
1,52	F 00V C10 512	F 00V C10 622	A1-23220/152
1,54	F 00V C10 514	F 00V C10 624	A1-23220/154
1,56	F 00V C10 516	F 00V C10 626	A1-23220/156
1,58	F 00V C10 518	F 00V C10 628	A1-23220/158
1,60	F 00V C10 520	F 00V C10 630	A1-23220/160
1,62	F 00V C10 522	F 00V C10 632	A1-23220/162
1,64	F 00V C10 524	F 00V C10 634	A1-23220/164
1,66	F 00V C10 526	F 00V C10 636	A1-23220/166
1,68	F 00V C10 528	F 00V C10 638	A1-23220/168
1,70	F 00V C10 530	F 00V C10 640	A1-23220/170
1,72	F 00V C10 532	F 00V C10 642	A1-23220/172
1,74	F 00V C10 534	F 00V C10 644	A1-23220/174
1,76	F 00V C10 536	F 00V C10 646	A1-23220/176
1,78	F 00V C10 538	F 00V C10 648	A1-23220/178
1,80	F 00V C10 540	F 00V C10 650	A1-23220/180

dia	cod. PERK
1,02	A1-23232/102
1,03	A1-23232/103
1,04	A1-23232/104
1,05	A1-23232/105
1,06	A1-23232/106
1,07	A1-23232/107
1,08	A1-23232/108
1,09	A1-23232/109
1,10	A1-23232/110
1,11	A1-23232/111
1,12	A1-23232/112
1,13	A1-23232/113
1,14	A1-23232/114
1,15	A1-23232/115
1,16	A1-23232/116
1,17	A1-23232/117
1,18	A1-23232/118
1,19	A1-23232/119
1,20	A1-23232/120
1,21	A1-23232/121
1,22	A1-23232/122
1,23	A1-23232/123
1,24	A1-23232/124
1,25	A1-23232/125

dia	ref. original	cod. PERK
8,409	F 00V C12 444	A1-23227/8409
8,421	F 00V C12 448	A1-23227/8421
8,433	F 00V C12 452	A1-23227/8433
8,445	F 00V C12 456	A1-23227/8445
8,457	F 00V C12 460	A1-23227/8457
8,469	F 00V C12 464	A1-23227/8469
8,481	F 00V C12 468	A1-23227/8481
8,493	F 00V C12 472	A1-23227/8493
8,505	F 00V C12 476	A1-23227/8505
8,517	F 00V C12 480	A1-23227/8517
8,529	F 00V C12 484	A1-23227/8529
8,541	F 00V C12 488	A1-23227/8541

## BOSCH

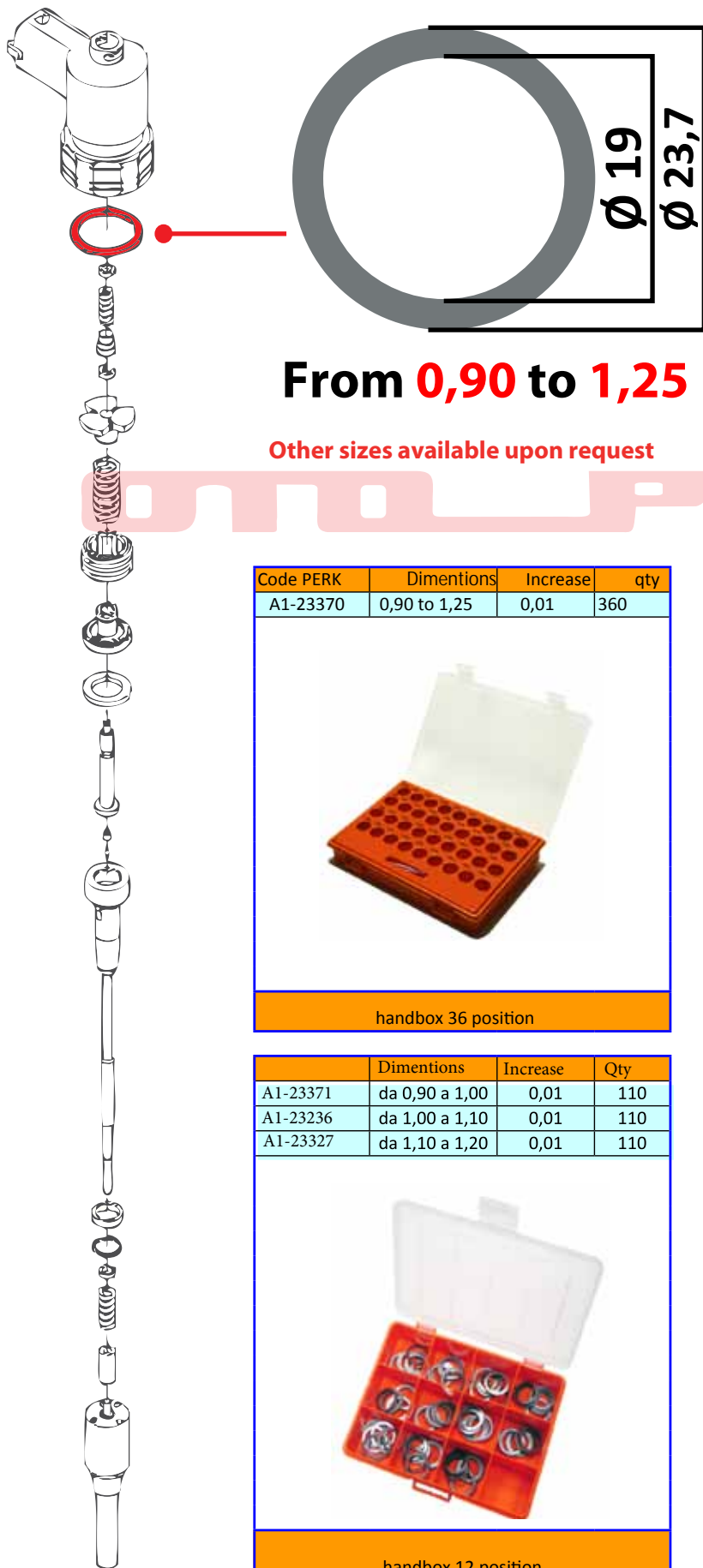

**From 0,90 to 1,25**

Other sizes available upon request

Code PERK	Dimintions	Increase	qty
A1-23370	0,90 to 1,25	0,01	360



handbox 36 position

	Dimintions	Increase	Qty
A1-23371	da 0,90 a 1,00	0,01	110
A1-23236	da 1,00 a 1,10	0,01	110
A1-23327	da 1,10 a 1,20	0,01	110



handbox 12 position

code individual thicknesses

dia	cod. PERK
0,90	A1-23236/090
0,91	A1-23236/091
0,92	A1-23236/092
0,93	A1-23236/093
0,94	A1-23236/094
0,95	A1-23236/095
0,96	A1-23236/096
0,97	A1-23236/097
0,98	A1-23236/098
0,99	A1-23236/099
1,00	A1-23236/100
1,01	A1-23236/101
1,02	A1-23236/102
1,03	A1-23236/103
1,04	A1-23236/104
1,05	A1-23236/105
1,06	A1-23236/106
1,07	A1-23236/107
1,08	A1-23236/108
1,09	A1-23236/109
1,10	A1-23236/110
1,11	A1-23236/111
1,12	A1-23236/112
1,13	A1-23236/113
1,14	A1-23236/114
1,15	A1-23236/115
1,16	A1-23236/116
1,17	A1-23236/117
1,18	A1-23236/118
1,19	A1-23236/119
1,20	A1-23236/120
1,21	A1-23236/121
1,22	A1-23236/122
1,23	A1-23236/123
1,24	A1-23236/124
1,25	A1-23236/125

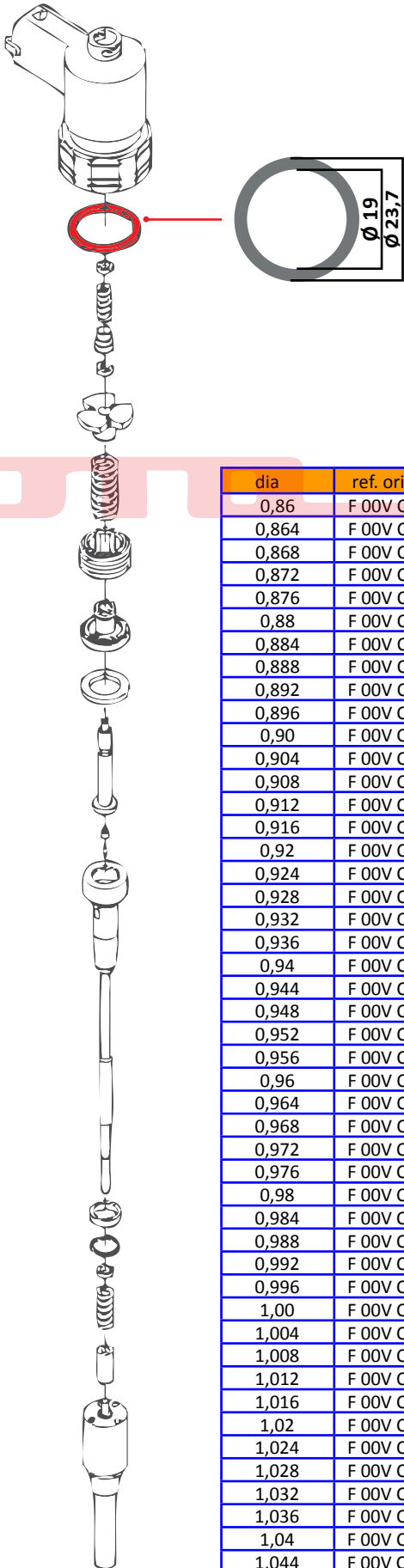

Code PERK	Dimensions	Increase	QTY
A1-23350	0,86 to 1,24	0,004	960



handbox 96 position

### Original No Cross Reference

dia	ref. original	cod PERK
0,86	F 00V C60 175	A1-23236/086
0,864	F 00V C60 177	A1-23236/0864
0,868	F 00V C60 179	A1-23236/0868
0,872	F 00V C60 181	A1-23236/0872
0,876	F 00V C60 183	A1-23236/0876
0,88	F 00V C60 185	A1-23236/088
0,884	F 00V C60 187	A1-23236/0884
0,888	F 00V C60 189	A1-23236/0888
0,892	F 00V C60 191	A1-23236/0892
0,896	F 00V C60 193	A1-23236/0896
0,90	F 00V C60 195	A1-23236/090
0,904	F 00V C60 197	A1-23236/0904
0,908	F 00V C60 199	A1-23236/0908
0,912	F 00V C60 201	A1-23236/0912
0,916	F 00V C60 203	A1-23236/0916
0,92	F 00V C60 205	A1-23236/092
0,924	F 00V C60 207	A1-23236/0924
0,928	F 00V C60 209	A1-23236/0928
0,932	F 00V C60 211	A1-23236/0932
0,936	F 00V C60 213	A1-23236/0936
0,94	F 00V C60 215	A1-23236/094
0,944	F 00V C60 217	A1-23236/0944
0,948	F 00V C60 219	A1-23236/0948
0,952	F 00V C60 221	A1-23236/0952
0,956	F 00V C60 223	A1-23236/0956
0,96	F 00V C60 225	A1-23236/096
0,964	F 00V C60 227	A1-23236/0964
0,968	F 00V C60 229	A1-23236/0968
0,972	F 00V C60 231	A1-23236/0972
0,976	F 00V C60 233	A1-23236/0976
0,98	F 00V C60 235	A1-23236/098
0,984	F 00V C60 237	A1-23236/0984
0,988	F 00V C60 239	A1-23236/0988
0,992	F 00V C60 241	A1-23236/0992
0,996	F 00V C60 243	A1-23236/0996
1,00	F 00V C60 245	A1-23236/100
1,004	F 00V C60 247	A1-23236/1004
1,008	F 00V C60 249	A1-23236/1008
1,012	F 00V C60 251	A1-23236/1012
1,016	F 00V C60 253	A1-23236/1016
1,02	F 00V C60 255	A1-23236/102
1,024	F 00V C60 257	A1-23236/1024
1,028	F 00V C60 259	A1-23236/1028
1,032	F 00V C60 261	A1-23236/1032
1,036	F 00V C60 263	A1-23236/1036
1,04	F 00V C60 265	A1-23236/104
1,044	F 00V C60 267	A1-23236/1044
1,048	F 00V C60 269	A1-23236/1048

dia	ref. original	cod PERK
1,052	F 00V C60 271	A1-23236/1052
1,056	F 00V C60 273	A1-23236/1056
1,06	F 00V C60 275	A1-23236/106
1,064	F 00V C60 277	A1-23236/1064
1,068	F 00V C60 279	A1-23236/1068
1,072	F 00V C60 281	A1-23236/1072
1,076	F 00V C60 283	A1-23236/1076
1,08	F 00V C60 285	A1-23236/108
1,084	F 00V C60 287	A1-23236/1084
1,088	F 00V C60 289	A1-23236/1088
1,092	F 00V C60 291	A1-23236/1092
1,096	F 00V C60 293	A1-23236/1096
1,10	F 00V C60 295	A1-23236/110
1,104	F 00V C60 297	A1-23236/1104
1,108	F 00V C60 299	A1-23236/1108
1,112	F 00V C60 301	A1-23236/1112
1,116	F 00V C60 303	A1-23236/1116
1,12	F 00V C60 305	A1-23236/112
1,124	F 00V C60 307	A1-23236/1124
1,128	F 00V C60 309	A1-23236/1128
1,132	F 00V C60 311	A1-23236/1132
1,136	F 00V C60 313	A1-23236/1136
1,14	F 00V C60 315	A1-23236/114
1,144	F 00V C60 317	A1-23236/1144
1,148	F 00V C60 319	A1-23236/1148
1,152	F 00V C60 321	A1-23236/1152
1,156	F 00V C60 323	A1-23236/1156
1,16	F 00V C60 325	A1-23236/116
1,164	F 00V C60 327	A1-23236/1164
1,168	F 00V C60 329	A1-23236/1168
1,172	F 00V C60 331	A1-23236/1172
1,176	F 00V C60 333	A1-23236/1176
1,18	F 00V C60 335	A1-23236/118
1,184	F 00V C60 337	A1-23236/1184
1,188	F 00V C60 339	A1-23236/1188
1,192	F 00V C60 341	A1-23236/1192
1,196	F 00V C60 343	A1-23236/1196
1,20	F 00V C60 345	A1-23236/120
1,204	F 00V C60 347	A1-23236/1204
1,208	F 00V C60 349	A1-23236/1208
1,212	F 00V C60 351	A1-23236/1212
1,216	F 00V C60 353	A1-23236/1216
1,22	F 00V C60 355	A1-23236/122
1,224	F 00V C60 357	A1-23236/1224
1,228	F 00V C60 359	A1-23236/1228
1,232	F 00V C60 361	A1-23236/1232
1,236	F 00V C60 363	A1-23236/1236
1,24	F 00V C60 365	A1-23236/124

## BOSCH

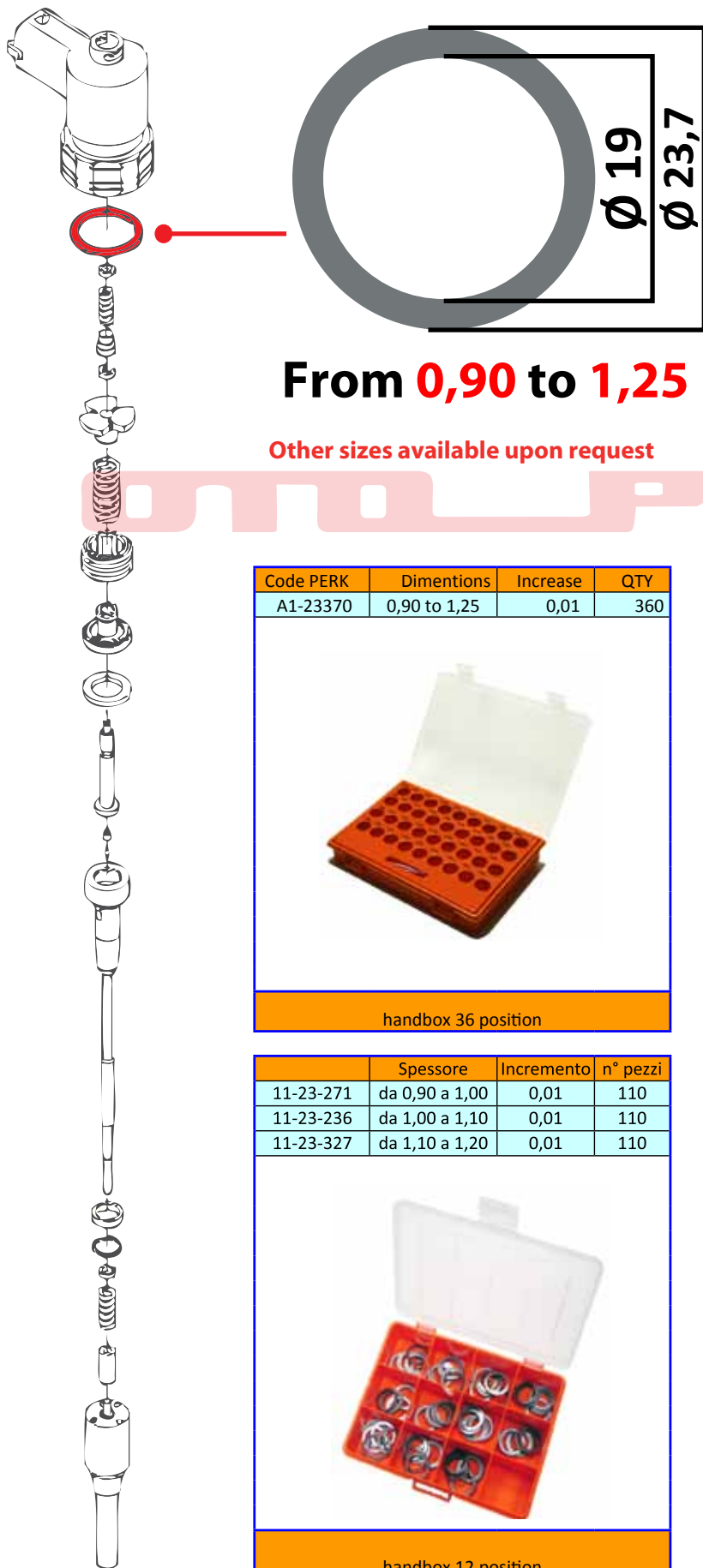

**From 0,90 to 1,25**

Other sizes available upon request

code individual thicknesses	
dia	cod. PERK
0,90	A1-23236/090
0,91	A1-23236/091
0,92	A1-23236/092
0,93	A1-23236/093
0,94	A1-23236/094
0,95	A1-23236/095
0,96	A1-23236/096
0,97	A1-23236/097
0,98	A1-23236/098
0,99	A1-23236/099
1,00	A1-23236/100
1,01	A1-23236/101
1,02	A1-23236/102
1,03	A1-23236/103
1,04	A1-23236/104
1,05	A1-23236/105
1,06	A1-23236/106
1,07	A1-23236/107
1,08	A1-23236/108
1,09	A1-23236/109
1,10	A1-23236/110
1,11	A1-23236/111
1,12	A1-23236/112
1,13	A1-23236/113
1,14	A1-23236/114
1,15	A1-23236/115
1,16	A1-23236/116
1,17	A1-23236/117
1,18	A1-23236/118
1,19	A1-23236/119
1,20	A1-23236/120
1,21	A1-23236/121
1,22	A1-23236/122
1,23	A1-23236/123
1,24	A1-23236/124
1,25	A1-23236/125

Code PERK	Dimentionis	Increase	QTY
A1-23370	0,90 to 1,25	0,01	360



handbox 36 position

	Spessore	Incremento	n° pezzi
11-23-271	da 0,90 a 1,00	0,01	110
11-23-236	da 1,00 a 1,10	0,01	110
11-23-327	da 1,10 a 1,20	0,01	110



handbox 12 position



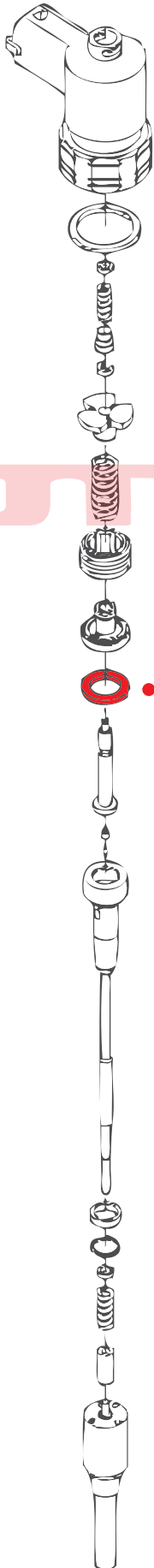

Original References

INCREMENTO: 0,004

Code PERK	dimentions	increase	QTY
A1-23373	1,19 to 1,33	0,04	360



handbox 36 position

### Original Cross Reference

dia	ref. original	Code PERK
1,19	F 00V C10 400	A1-23219/119
1,194	F 00V C10 402	A1-23219/1194
1,198	F 00V C10 404	A1-23219/1198
1,202	F 00V C10 406	A1-23219/1202
1,206	F 00V C10 408	A1-23219/1206
1,21	F 00V C10 410	A1-23219/121
1,214	F 00V C10 412	A1-23219/1214
1,218	F 00V C10 414	A1-23219/1218
1,222	F 00V C10 416	A1-23219/1222
1,226	F 00V C10 418	A1-23219/1226
1,23	F 00V C10 420	A1-23219/123
1,234	F 00V C10 422	A1-23219/1234
1,238	F 00V C10 424	A1-23219/1238
1,242	F 00V C10 426	A1-23219/1242
1,246	F 00V C10 428	A1-23219/1246
1,25	F 00V C10 430	A1-23219/125
1,254	F 00V C10 432	A1-23219/1254
1,258	F 00V C10 434	A1-23219/1258
1,262	F 00V C10 436	A1-23219/1262
1,266	F 00V C10 438	A1-23219/1266
1,27	F 00V C10 440	A1-23219/127
1,274	F 00V C10 442	A1-23219/1274
1,278	F 00V C10 444	A1-23219/1278
1,282	F 00V C10 446	A1-23219/1282
1,286	F 00V C10 448	A1-23219/1286
1,29	F 00V C10 450	A1-23219/129
1,294	F 00V C10 452	A1-23219/1294
1,298		A1-23219/1298
1,302		A1-23219/1302
1,306		A1-23219/1306
1,310		A1-23219/460
1,314		A1-23219/1314
1,318		A1-23219/1318
1,322		A1-23219/1322
1,326		A1-23219/1326
1,330		A1-23219/1330

## BOSCH

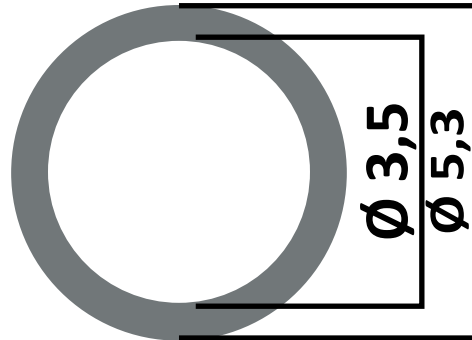

**From 0,90 to 2,00**

Other sizes available upon request

Code PERK	Dimentions	Increase	QTY
A1-23244	1,20 to 1,70	0,05	110



handbox 12 position

Code PERK	Dimentions	Increase	QTY
A1-23269	0,90 to 1,90	0,05	210
A1-23220	1,20 to 1,70	0,02	240
A1-23264	1,40 to 1,86	0,02	240



handbox 24 position

code individual thicknesses

dia	cod. PERK
0,90	A1-23220/090
0,95	A1-23220/095
1,00	A1-23220/100
1,05	A1-23220/105
1,10	A1-23220/110
1,15	A1-23220/115
1,20	A1-23220/120
1,22	A1-23220/122
1,24	A1-23220/124
1,25	A1-23220/125
1,26	A1-23220/126
1,28	A1-23220/128
1,30	A1-23220/130
1,32	A1-23220/132
1,34	A1-23220/134
1,35	A1-23220/135
1,36	A1-23220/136
1,38	A1-23220/138
1,40	A1-23220/140
1,42	A1-23220/142
1,44	A1-23220/144
1,45	A1-23220/145
1,46	A1-23220/146
1,48	A1-23220/148
1,50	A1-23220/150
1,52	A1-23220/152
1,54	A1-23220/154
1,55	A1-23220/155
1,56	A1-23220/156
1,58	A1-23220/158
1,60	A1-23220/160
1,62	A1-23220/162
1,64	A1-23220/164
1,65	A1-23220/165
1,66	A1-23220/166
1,68	A1-23220/168
1,70	A1-23220/170
1,72	A1-23220/172
1,74	A1-23220/174
1,75	A1-23220/175
1,76	A1-23220/176
1,78	A1-23220/178
1,80	A1-23220/180
1,82	A1-23220/182
1,84	A1-23220/184
1,85	A1-23220/185
1,86	A1-23220/186
1,90	A1-23220/190
1,95	A1-23220/195
2,00	A1-23220/200

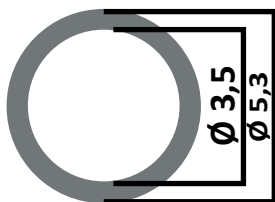
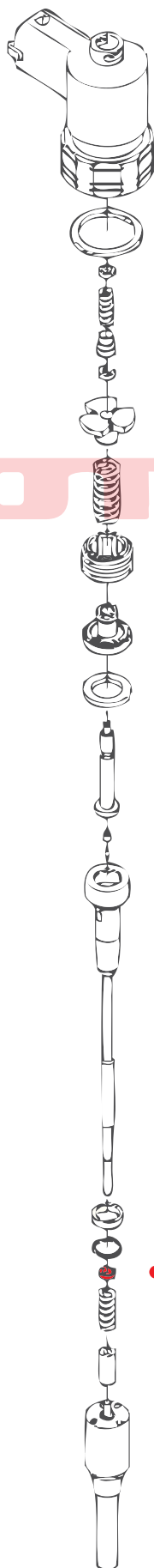

### Original Cross Reference

dia	ref. original 1	ref. original 2	cod PERK
1,00	F 00V C10 460	F 00V C10 570	A1-23220/100
1,02	F 00V C10 462	F 00V C10 572	A1-23220/102
1,04	F 00V C10 464	F 00V C10 574	A1-23220/104
1,06	F 00V C10 466	F 00V C10 576	A1-23220/106
1,08	F 00V C10 468	F 00V C10 578	A1-23220/108
1,10	F 00V C10 470	F 00V C10 580	A1-23220/110
1,12	F 00V C10 472	F 00V C10 582	A1-23220/112
1,14	F 00V C10 474	F 00V C10 584	A1-23220/114
1,16	F 00V C10 476	F 00V C10 586	A1-23220/116
1,18	F 00V C10 478	F 00V C10 588	A1-23220/118
1,20	F 00V C10 480	F 00V C10 590	A1-23220/120
1,22	F 00V C10 482	F 00V C10 592	A1-23220/122
1,24	F 00V C10 484	F 00V C10 594	A1-23220/124
1,26	F 00V C10 486	F 00V C10 596	A1-23220/126
1,28	F 00V C10 488	F 00V C10 598	A1-23220/128
1,30	F 00V C10 490	F 00V C10 600	A1-23220/130
1,32	F 00V C10 492	F 00V C10 602	A1-23220/132
1,34	F 00V C10 494	F 00V C10 604	A1-23220/134
1,36	F 00V C10 496	F 00V C10 606	A1-23220/136
1,38	F 00V C10 498	F 00V C10 608	A1-23220/138
1,40	F 00V C10 500	F 00V C10 610	A1-23220/140
1,42	F 00V C10 502	F 00V C10 612	A1-23220/142
1,44	F 00V C10 504	F 00V C10 614	A1-23220/144
1,46	F 00V C10 506	F 00V C10 616	A1-23220/146
1,48	F 00V C10 508	F 00V C10 618	A1-23220/148
1,50	F 00V C10 510	F 00V C10 620	A1-23220/150
1,52	F 00V C10 512	F 00V C10 622	A1-23220/152
1,54	F 00V C10 514	F 00V C10 624	A1-23220/154
1,56	F 00V C10 516	F 00V C10 626	A1-23220/156
1,58	F 00V C10 518	F 00V C10 628	A1-23220/158
1,60	F 00V C10 520	F 00V C10 630	A1-23220/160
1,62	F 00V C10 522	F 00V C10 632	A1-23220/162
1,64	F 00V C10 524	F 00V C10 634	A1-23220/164
1,66	F 00V C10 526	F 00V C10 636	A1-23220/166
1,68	F 00V C10 528	F 00V C10 638	A1-23220/168
1,70	F 00V C10 530	F 00V C10 640	A1-23220/170
1,72	F 00V C10 532	F 00V C10 642	A1-23220/172
1,74	F 00V C10 534	F 00V C10 644	A1-23220/174
1,76	F 00V C10 536	F 00V C10 646	A1-23220/176
1,78	F 00V C10 538	F 00V C10 648	A1-23220/178
1,80	F 00V C10 540	F 00V C10 650	A1-23220/180
1,82	F 00V C10 542	F 00V C10 652	A1-23220/182
1,84	F 00V C10 544	F 00V C10 654	A1-23220/184
1,86	F 00V C10 546	F 00V C10 656	A1-23220/186
1,88	F 00V C10 548	F 00V C10 658	A1-23220/188
1,90	F 00V C10 550	F 00V C10 660	A1-23220/190
1,92	F 00V C10 552	F 00V C10 662	A1-23220/192
1,94	F 00V C10 554	F 00V C10 664	A1-23220/194
1,96	F 00V C10 556	F 00V C10 666	A1-23220/196
1,98	F 00V C10 558	F 00V C10 668	A1-23220/198
2,00	F 00V C10 560	F 00V C10 670	A1-23220/200

Code PERK	Dimintions	Increase	QTY
A1-23374	1,00 to 2,00	0,02	510



handbox 54 position

## BOSCH

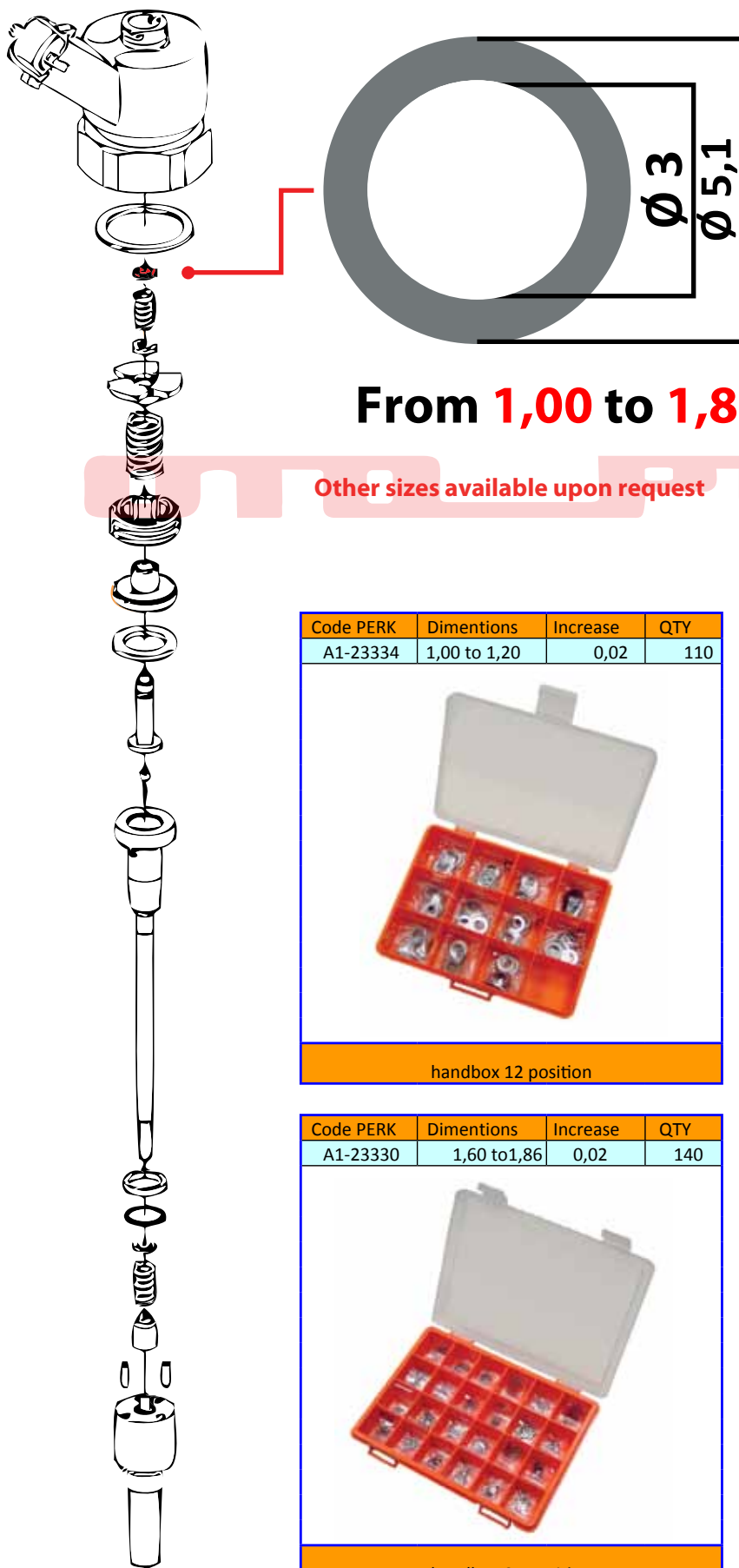

**From 1,00 to 1,86**

Other sizes available upon request

Code PERK	Dimentions	Increase	QTY
A1-23334	1,00 to 1,20	0,02	110



handbox 12 position

Code PERK	Dimentions	Increase	QTY
A1-23330	1,60 to 1,86	0,02	140



handbox 24 position

code individual thicknesses

dia	cod. PERK
1,00	A1-23330/100
1,02	A1-23330/102
1,04	A1-23330/104
1,06	A1-23330/106
1,08	A1-23330/108
1,10	A1-23330/110
1,12	A1-23330/112
1,14	A1-23330/114
1,16	A1-23330/116
1,18	A1-23330/118
1,20	A1-23330/120
1,40	A1-23330/122
1,60	A1-23330/160
1,62	A1-23330/162
1,64	A1-23330/164
1,66	A1-23330/166
1,68	A1-23330/168
1,70	A1-23330/170
1,72	A1-23330/172
1,74	A1-23330/174
1,76	A1-23330/176
1,78	A1-23330/178
1,80	A1-23330/180
1,82	A1-23330/182
1,84	A1-23330/184
1,86	A1-23330/186

## BOSCH

www.eurodiesel.com

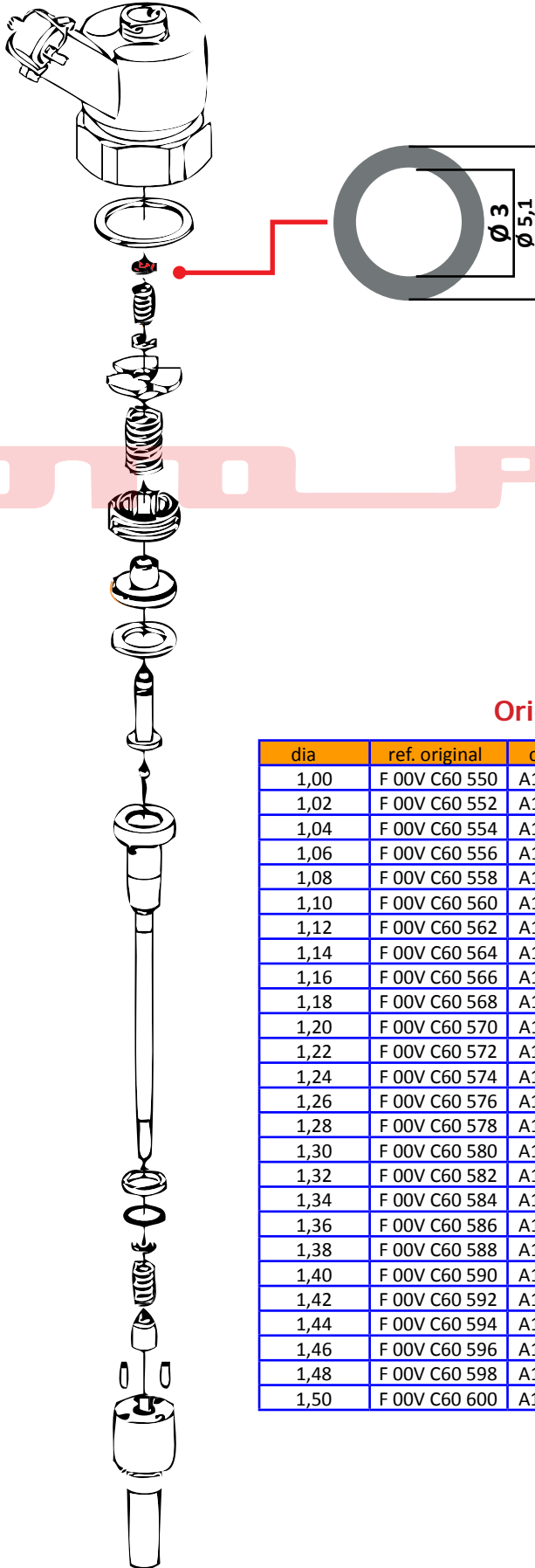

Code PERK	Dimintions	Increase	QTY
A1-23375	1,00 to 2,00	0,02	510



handbox 54 position

### Original Cross Reference

dia	ref. original	cod PERK
1,00	F 00V C60 550	A1-23330/100
1,02	F 00V C60 552	A1-23330/102
1,04	F 00V C60 554	A1-23330/104
1,06	F 00V C60 556	A1-23330/106
1,08	F 00V C60 558	A1-23330/108
1,10	F 00V C60 560	A1-23330/110
1,12	F 00V C60 562	A1-23330/112
1,14	F 00V C60 564	A1-23330/114
1,16	F 00V C60 566	A1-23330/116
1,18	F 00V C60 568	A1-23330/118
1,20	F 00V C60 570	A1-23330/120
1,22	F 00V C60 572	A1-23330/122
1,24	F 00V C60 574	A1-23330/124
1,26	F 00V C60 576	A1-23330/126
1,28	F 00V C60 578	A1-23330/128
1,30	F 00V C60 580	A1-23330/130
1,32	F 00V C60 582	A1-23330/132
1,34	F 00V C60 584	A1-23330/134
1,36	F 00V C60 586	A1-23330/136
1,38	F 00V C60 588	A1-23330/138
1,40	F 00V C60 590	A1-23330/140
1,42	F 00V C60 592	A1-23330/142
1,44	F 00V C60 594	A1-23330/144
1,46	F 00V C60 596	A1-23330/146
1,48	F 00V C60 598	A1-23330/148
1,50	F 00V C60 600	A1-23330/150

dia	ref. original	cod PERK
1,52	F 00V C60 602	A1-23330/152
1,54	F 00V C60 604	A1-23330/154
1,56	F 00V C60 606	A1-23330/156
1,58	F 00V C60 608	A1-23330/158
1,60	F 00V C60 610	A1-23330/160
1,62	F 00V C60 612	A1-23330/162
1,64	F 00V C60 614	A1-23330/164
1,66	F 00V C60 616	A1-23330/166
1,68	F 00V C60 618	A1-23330/168
1,70	F 00V C60 620	A1-23330/170
1,72	F 00V C60 622	A1-23330/172
1,74	F 00V C60 624	A1-23330/174
1,76	F 00V C60 626	A1-23330/176
1,78	F 00V C60 628	A1-23330/178
1,80	F 00V C60 630	A1-23330/180
1,82	F 00V C60 632	A1-23330/182
1,84	F 00V C60 634	A1-23330/184
1,86	F 00V C60 636	A1-23330/186
1,88	F 00V C60 638	A1-23330/188
1,90	F 00V C60 640	A1-23330/190
1,92	F 00V C60 642	A1-23330/192
1,94	F 00V C60 644	A1-23330/194
1,96	F 00V C60 646	A1-23330/196
1,98	F 00V C60 648	A1-23330/198
2,00	F 00V C60 650	A1-23330/200

OTO PERK.A.S 7419/12 Sokak No:22, 5. Site 35060 - Izmir / Turkiye



## BOSCH

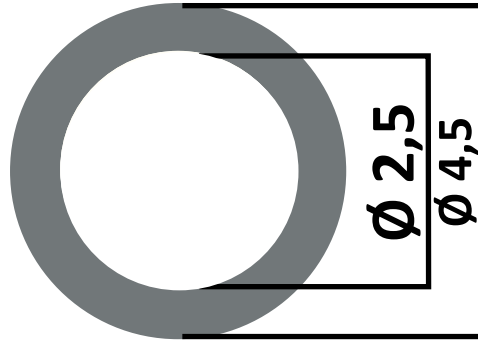
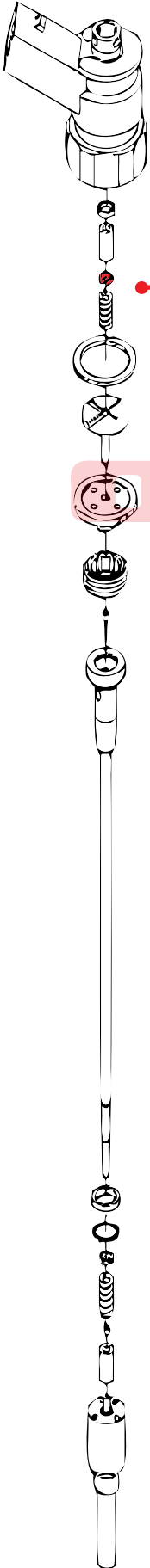

From **1,20** to **1,86**

Other sizes available upon request

Code PERK	Dimentions	Increase	QTY
A1-23245	1,20 to 1,70	0,05	110
A1-23263	1,64 to 1,86	0,02	120



handbox 12 position

Code PERK	Dimentions	Increase	QTY
A1-23230	1,20 to 1,70	0,02	240



handbox 24 position

code individual thicknesses

dia	cod. PERK
1,20	A1-23230/120
1,22	A1-23230/122
1,24	A1-23230/124
1,25	A1-23230/125
1,26	A1-23230/126
1,28	A1-23230/128
1,30	A1-23230/130
1,32	A1-23230/132
1,34	A1-23230/134
1,35	A1-23230/135
1,36	A1-23230/136
1,38	A1-23230/138
1,40	A1-23230/140
1,42	A1-23230/142
1,44	A1-23230/144
1,45	A1-23230/145
1,46	A1-23230/146
1,48	A1-23230/148
1,50	A1-23230/150
1,52	A1-23230/152
1,54	A1-23230/154
1,55	A1-23230/155
1,56	A1-23230/156
1,58	A1-23230/158
1,60	A1-23230/160
1,62	A1-23230/162
1,64	A1-23230/164
1,65	A1-23230/165
1,66	A1-23230/166
1,68	A1-23230/168
1,70	A1-23230/170
1,72	A1-23230/172
1,74	A1-23230/174
1,76	A1-23230/176
1,78	A1-23230/178
1,80	A1-23230/180
1,82	A1-23230/182
1,84	A1-23230/184
1,86	A1-23230/186

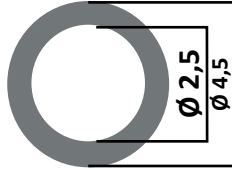
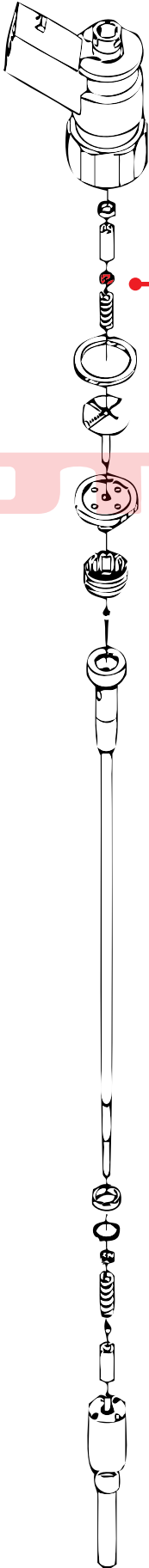

Code PERK	Dimintions	Increase	QTY
A1-23376	0,20 to 1,90	0,02	360

handbox 36 position

### Original Cross Reference

dia	ref. original	cod. PERK
1,20		A1-23230/120
1,22		A1-23230/122
1,24		A1-23230/124
1,26		A1-23230/126
1,28		A1-23230/128
1,30		A1-23230/130
1,32		A1-23230/132
1,34		A1-23230/134
1,36		A1-23230/136
1,38		A1-23230/138
1,40	F 00V C60 485	A1-23-230/140
1,42	F 00V C60 487	A1-23230/142
1,44	F 00V C60 489	A1-23230/144
1,46	F 00V C60 491	A1-23230/146
1,48	F 00V C60 493	A1-23230/148
1,50	F 00V C60 495	A1-23230/150
1,52	F 00V C60 497	A1-23230/152
1,54	F 00V C60 499	A1-23-230/154
1,56	F 00V C60 501	A1-23230/156
1,58	F 00V C60 503	A1-23230/158
1,60	F 00V C60 505	A1-23230/160
1,62	F 00V C60 507	A1-23230/162
1,64	F 00V C60 509	A1-23230/164
1,66	F 00V C60 511	A1-23230/166
1,68	F 00V C60 513	A1-23230/168
1,70	F 00V C60 515	A1-23230/170
1,72	F 00V C60 517	A1-23230/172
1,74	F 00V C60 519	A1-23230/174
1,76	F 00V C60 521	A1-23230/176
1,78	F 00V C60 523	A1-23230/178
1,80	F 00V C60 525	A1-23230/180
1,82	F 00V C60 527	A1-23230/182
1,84	F 00V C60 529	A1-23230/184
1,86	F 00V C60 531	A1-23230/186
1,88	F 00V C60 533	A1-23230/188
1,90	F 00V C60 535	A1-23230/190

## BOSCH

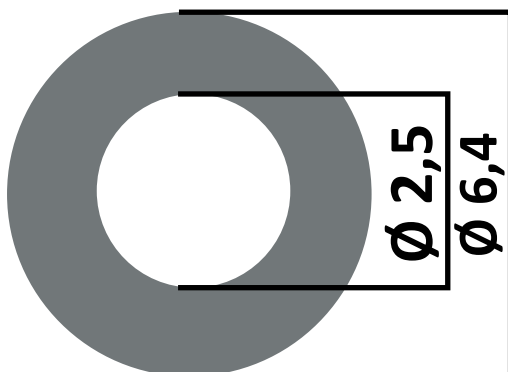
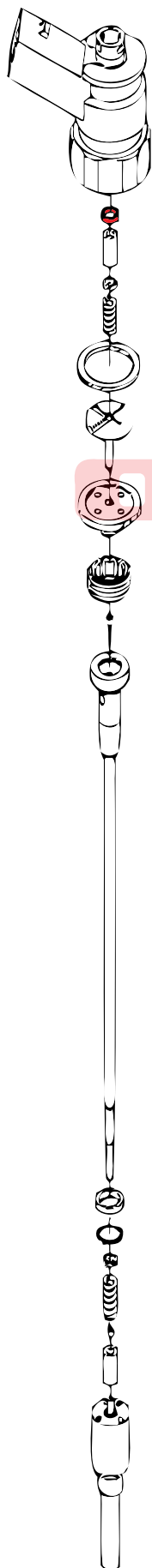

**From 1,00 to 1,40**

Other sizes available upon request

根据要求提供其它尺寸

Code PERK	Dimintions	Increase	QTY
A1-23329	1,20 to 1,30	0,01	110



handbox 12 position

Code PERK	Dimintions	Increase	QTY
A1-23377	1,00 to 1,40	0,01	410



handbox 54 position

code individual thicknesses

dia	cod. PERK
1,00	A1-23329/100
1,01	A1-23329/101
1,02	A1-23329/102
1,03	A1-23329/103
1,04	A1-23329/104
1,05	A1-23329/105
1,06	A1-23329/106
1,07	A1-23329/107
1,08	A1-23329/108
1,09	A1-23329/109
1,10	A1-23329/110
1,11	A1-23329/111
1,12	A1-23329/112
1,13	A1-23329/113
1,14	A1-23329/114
1,15	A1-23329/115
1,16	A1-23329/116
1,17	A1-23329/117
1,18	A1-23329/118
1,19	A1-23329/119
1,20	A1-23329/120
1,21	A1-23329/121
1,22	A1-23329/122
1,23	A1-23329/123
1,24	A1-23329/124
1,25	A1-23329/125
1,26	A1-23329/126
1,27	A1-23329/127
1,28	A1-23329/128
1,29	A1-23329/129
1,30	A1-23329/130
1,31	A1-23329/131
1,32	A1-23329/132
1,33	A1-23329/133
1,34	A1-23329/134
1,35	A1-23329/135
1,36	A1-23329/136
1,37	A1-23329/137
1,38	A1-23329/138
1,39	A1-23329/139
1,40	A1-23329/140

## BOSCH

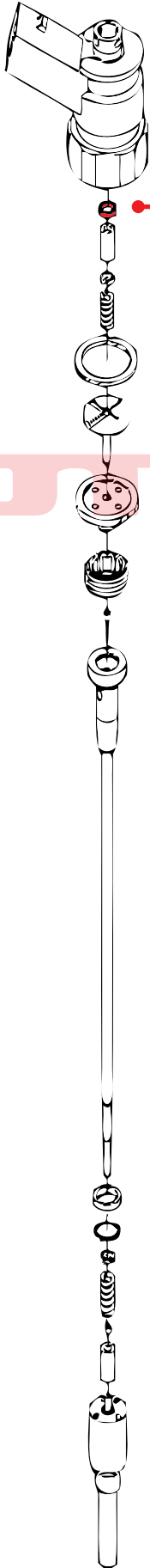

Code PERK	Dimensions	Increase	QTY
A1-23378	1,089 to 1,368	0,009	340



handbox 36 position

### Original Cross Reference

dia	ref. original	cod PERK
1,089	F 00V C60 386	A1-23329/1089
1,098	F 00V C60 389	A1-23329/1098
1,107	F 00V C60 392	A1-23329/1107
1,116	F 00V C60 395	A1-23329/1116
1,125	F 00V C60 398	A1-23329/1125
1,134	F 00V C60 401	A1-23329/1134
1,143	F 00V C60 404	A1-23329/1143
1,152	F 00V C60 407	A1-23329/1152
1,161	F 00V C60 410	A1-23329/1161
1,17	F 00V C60 413	A1-23329/1170
1,179	F 00V C60 416	A1-23329/1179
1,188	F 00V C60 419	A1-23329/1188
1,197	F 00V C60 422	A1-23329/1197
1,206	F 00V C60 425	A1-23329/1206
1,215	F 00V C60 428	A1-23329/1215
1,224	F 00V C60 431	A1-23329/1224
1,233	F 00V C60 434	A1-23329/1233
1,242	F 00V C60 437	A1-23329/1242
1,251	F 00V C60 440	A1-23329/1251
1,26	F 00V C60 443	A1-23329/1260
1,269	F 00V C60 446	A1-23329/1269
1,278	F 00V C60 449	A1-23329/1278
1,287	F 00V C60 452	A1-23329/1287
1,296	F 00V C60 455	A1-23329/1296
1,305	F 00V C60 458	A1-23329/1305
1,314	F 00V C60 461	A1-23329/1314
1,323	F 00V C60 464	A1-23329/1323
1,332	F 00V C60 467	A1-23329/1332
1,341	F 00V C60 470	A1-23329/1341
1,35	F 00V C60 473	A1-23329/1350
1,359	F 00V C60 476	A1-23329/1359
1,368	F 00V C60 479	A1-23329/1368

## BOSCH

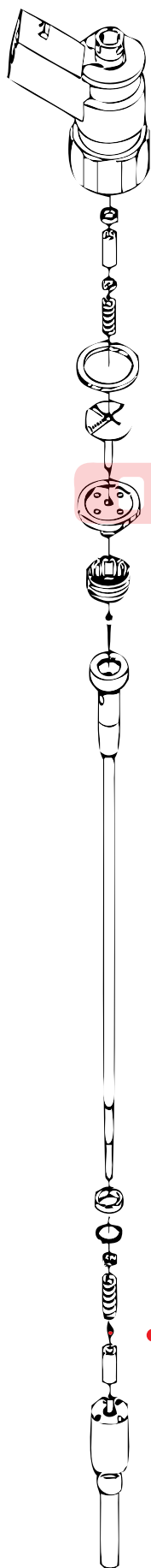

PASTIGLIETTA  
tablet

From **0,90** to **1,40**

Other sizes available upon request

Code PERK	Dimintions	Increase	QTY
A1-23305	0,90 to 1,01	0,01	120
A1-23306	1,02 to 1,13	0,01	120
A1-23232	1,14 to 1,25	0,01	120



handbox 12 position

Code PERK	Dimintions	Increase	QTY
A1-23283	0,95 to 1,13	0,01	190



handbox 24 position

code individual thicknesses	
dia	cod. PERK
0,90	A1-23232/090
0,91	A1-23232/091
0,92	A1-23232/092
0,93	A1-23232/093
0,94	A1-23232/094
0,95	A1-23232/095
0,96	A1-23232/096
0,97	A1-23232/097
0,98	A1-23232/098
0,99	A1-23232/099
1,00	A1-23232/100
1,01	A1-23232/101
1,02	A1-23232/102
1,03	A1-23232/103
1,04	A1-23232/104
1,05	A1-23232/105
1,06	A1-23232/106
1,07	A1-23-32/107
1,08	A1-23232/108
1,09	A1-23232/109
1,10	A1-23232/110
1,11	A1-23232/111
1,12	A1-23232/112
1,13	A1-23232/113
1,14	A1-23232/114
1,15	A1-23232/115
1,16	A1-23232/116
1,17	A1-23232/117
1,18	A1-23232/118
1,19	A1-23232/119
1,20	A1-23232/120
1,21	A1-23232/121
1,22	A1-23232/122
1,23	A1-23232/123
1,24	A1-23232/124
1,25	A1-23232/125
1,26	A1-23232/126
1,27	A1-23232/127
1,28	A1-23232/128
1,29	A1-23232/129
1,30	A1-23232/130
1,31	A1-23232/131
1,32	A1-23232/132
1,33	A1-23232/133
1,34	A1-23232/134
1,35	A1-23232/135
1,36	A1-23232/136
1,37	A1-23232/137
1,38	A1-23232/138
1,39	A1-23232/139
1,40	A1-23232/140



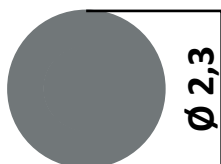
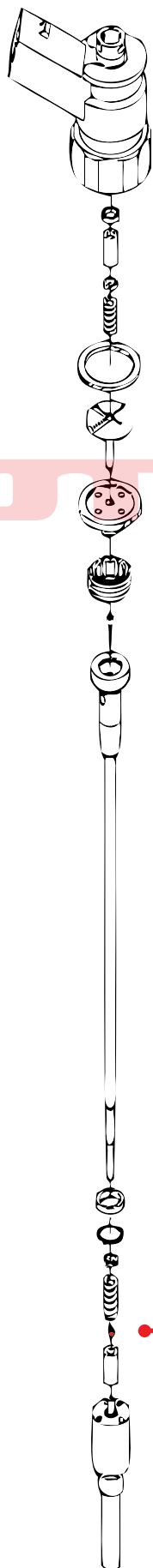

Code PERK	Dimentions	Increase	QTY
A1-23379	1,00 to 1,36	0,01	370



handbox 54 position

### Original Cross Reference

dia	ref. original	Cod PERK
1,00	F 00V C12 500	A1-23232/100
1,01	F 00V C12 502	A1-23232/101
1,02	F 00V C12 504	A1-23232/102
1,03	F 00V C12 506	A1-23232/103
1,04	F 00V C12 508	A1-23232/104
1,05	F 00V C12 510	A1-23232/105
1,06	F 00V C12 512	A1-23232/106
1,07	F 00V C12 514	A1-23232/107
1,08	F 00V C12 516	A1-23232/108
1,09	F 00V C12 518	A1-23232/109
1,10	F 00V C12 520	A1-23232/110
1,11	F 00V C12 522	A1-23232/111
1,12	F 00V C12 524	A1-23232/112
1,13	F 00V C12 526	A1-23232/113
1,14	F 00V C12 528	A1-23232/114
1,15	F 00V C12 530	A1-23232/115
1,16	F 00V C12 532	A1-23232/116
1,17	F 00V C12 534	A1-23232/117
1,18	F 00V C12 536	A1-23232/118
1,19	F 00V C12 538	A1-23232/119
1,20	F 00V C12 540	A1-23232/120
1,21	F 00V C12 542	A1-23232/121
1,22	F 00V C12 544	A1-23232/122
1,23	F 00V C12 546	A1-23232/123
1,24	F 00V C12 548	A1-23232/124
1,25	F 00V C12 550	A1-23232/125
1,26	F 00V C12 552	A1-23232/126
1,27	F 00V C12 554	A1-23232/127
1,28	F 00V C12 556	A1-23232/128
1,29	F 00V C12 558	A1-23232/129
1,30	F 00V C12 560	A1-23232/130
1,31	F 00V C12 562	A1-23232/131
1,32	F 00V C12 564	A1-23232/132
1,33	F 00V C12 566	A1-23232/133
1,34	F 00V C12 568	A1-23232/134
1,35	F 00V C12 570	A1-23232/135
1,36	F 00V C12 572	A1-23232/136

## BOSCH

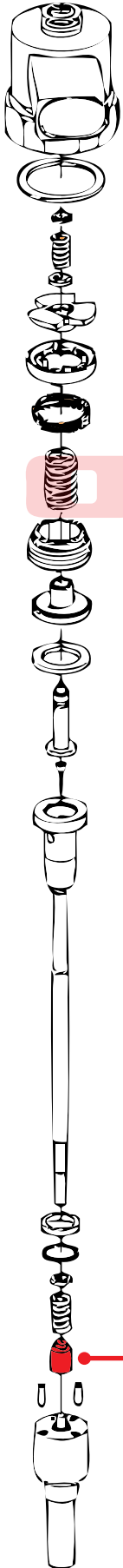

Old Version

cylindrical pin

**From 8,40 to 8,70**

Other sizes available upon request

根据要求提供其它尺寸

Code PERK	Dimentions	Increase	QTY
A1-23274	8,50 to 8,70	0,01	210



handbox 24 position

Code PERK	Dimentions	Increase	QTY
A1-23227	8,40 to 8,50	0,01	110



hanbox 12 position

Code PERK	Dimentions	Increase	QTY
A1-23299	8,40 to 8,70	0,01	310



handbox 36 position

code individual thicknesses

misura	cod. PERK
8,40	A1-23227/840
8,41	A1-23227/841
8,42	A1-23227/842
8,43	A1-23227/843
8,44	A1-23227/844
8,45	A1-23227/845
8,46	A1-23227/846
8,47	A1-23227/847
8,48	A1-23227/848
8,49	A1-23227/849
8,50	A1-23227/850
8,51	A1-23227/851
8,52	A1-23227/852
8,53	A1-23227/853
8,54	A1-23227/854
8,55	A1-23227/855
8,56	A1-23227/856
8,57	A1-23227/857
8,58	A1-23227/858
8,59	A1-23227/859
8,60	A1-23227/860
8,61	A1-23227/861
8,62	A1-23227/862
8,63	A1-23227/863
8,64	A1-23227/864
8,65	A1-23227/865
8,66	A1-23227/866
8,67	A1-23227/867
8,68	A1-23227/868
8,69	A1-23227/869
8,70	A1-23227/870

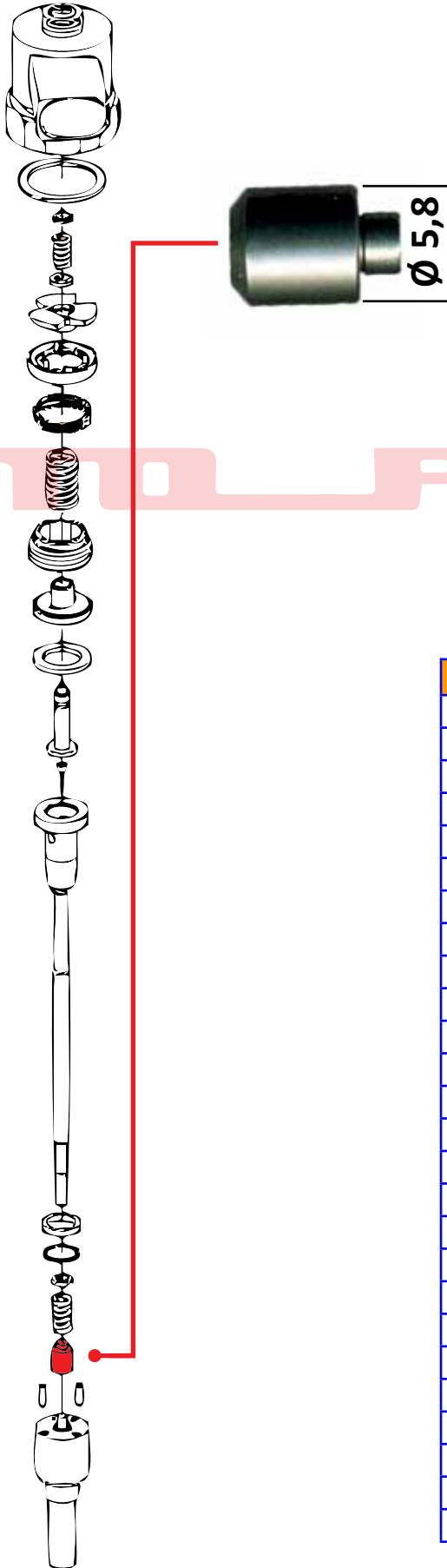

Code PERK	Dimentions	Increase	QTY
A1-23380	8,277 to 8,571	0,012	260



handbox 36 position

### Old Version

### Original Cross Reference

dia	ref. original	Cod PERK
8,277	F 00V C12 400	A1-23227/8277
8,289	F 00V C12 404	A1-23227/8289
8,301	F 00V C12 408	A1-23227/8301
8,313	F 00V C12 412	A1-23227/8313
8,325	F 00V C12 416	A1-23227/8325
8,337	F 00V C12 420	A1-23227/8337
8,349	F 00V C12 424	A1-23227/8349
8,361	F 00V C12 428	A1-23227/8361
8,373	F 00V C12 432	A1-23227/8373
8,385	F 00V C12 436	A1-23227/8385
8,397	F 00V C12 440	A1-23227/8397
8,409	F 00V C12 444	A1-23227/8409
8,421	F 00V C12 448	A1-23227/8421
8,433	F 00V C12 452	A1-23227/8433
8,445	F 00V C12 456	A1-23227/8445
8,457	F 00V C12 460	A1-23227/8457
8,469	F 00V C12 464	A1-23227/8469
8,481	F 00V C12 468	A1-23227/8481
8,493	F 00V C12 472	A1-23227/8493
8,505	F 00V C12 476	A1-23227/8505
8,517	F 00V C12 480	A1-23227/8517
8,529	F 00V C12 484	A1-23227/8529
8,541	F 00V C12 488	A1-23227/8541
8,553	F 00V C12 492	A1-23227/8553
8,565	F 00V C12 496	A1-23227/8565
8,571	F 00V C12 498	A1-23227/8571

## BOSCH

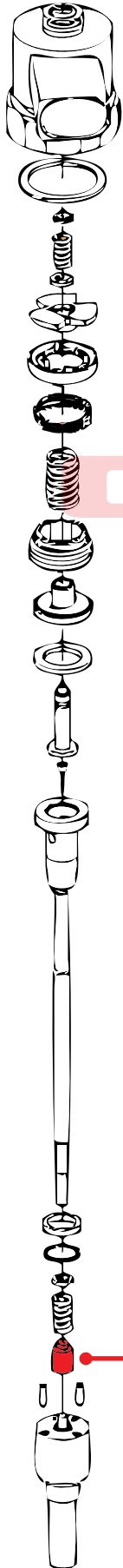

**New Version**

**cylindrical pin**

**From 8,40 to 8,70**

Other sizes available upon request

根据要求提供其它尺寸

Code PERK	Dimintions	Increase	QTY
A1-23723	8,50 to 8,70	0,01	210



handbox 24 position

Code PERK	Dimintions	Increase	QTY
A1-23724	8,40 to 8,50	0,01	110



handbox 12 position

Code PERK	Dimintions	Increase	QTY
A1-23725	8,40 to 8,70	0,01	310



handbox 36 position

code individual thicknesses

dia	cod. PERK
8,40	A1-23723/840
8,41	A1-2723/841
8,42	A1-23-723/842
8,43	A1-23723/843
8,44	A1-23723/844
8,45	A1-23723/845
8,46	A1-23723/846
8,47	A1-23723/847
8,48	A1-23723/848
8,49	A1-23723/849
8,50	A1-23723/850
8,51	A1-23723/851
8,52	A1-23723/852
8,53	A1-23723/853
8,54	A1-23723/854
8,55	A1-23723/855
8,56	A1-23723/856
8,57	A1-23723/857
8,58	A1-23723/858
8,59	A1-23723/859
8,60	A1-23723/860
8,61	A1-23723/861
8,62	A1-23723/862
8,63	A1-23723/863
8,64	A1-23723/864
8,65	A1-23723/865
8,66	A1-23723/866
8,67	A1-23723/867
8,68	A1-23723/868
8,69	A1-23723/869
8,70	A1-23723/870

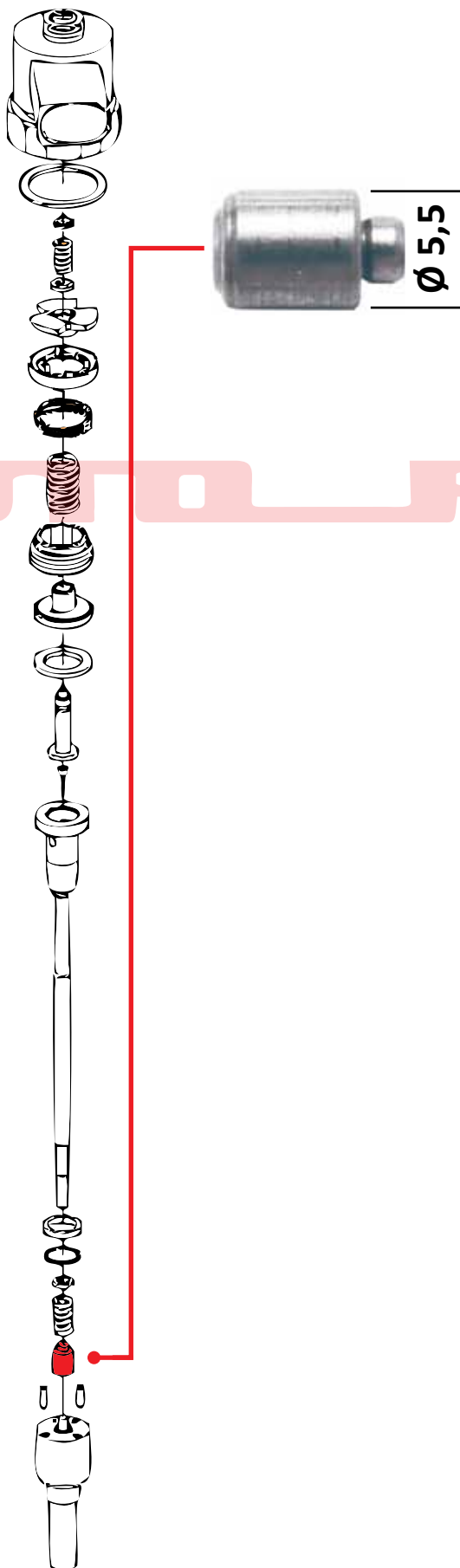

Code PERK	Dimentions	Increase	QTY
A1-23726	8,277 to 8,571	0,012	260



handbox 36 position

### New Version Original Cross Reference

dia	ref. original	cod PERK
8,277	F 00V C12 400	A1-23723/8277
8,289	F 00V C12 404	A1-23723/8289
8,301	F 00V C12 408	A1-23723/8301
8,313	F 00V C12 412	A1-23723/8313
8,325	F 00V C12 416	A1-23723/8325
8,337	F 00V C12 420	A1-23723/8337
8,349	F 00V C12 424	A1-23723/8349
8,361	F 00V C12 428	A1-23723/8361
8,373	F 00V C12 432	A1-23723/8373
8,385	F 00V C12 436	A1-23723/8385
8,397	F 00V C12 440	A1-23723/8397
8,409	F 00V C12 444	A1-23723/8409
8,421	F 00V C12 448	A1-23723/8421
8,433	F 00V C12 452	A1-23723/8433
8,445	F 00V C12 456	A1-23723/8445
8,457	F 00V C12 460	A1-23723/8457
8,469	F 00V C12 464	A1-23723/8469
8,481	F 00V C12 468	A1-23723/8481
8,493	F 00V C12 472	A1-23723/8493
8,505	F 00V C12 476	A1-23723/8505
8,517	F 00V C12 480	A1-23723/8517
8,529	F 00V C12 484	A1-23723/8529
8,541	F 00V C12 488	A1-23723/8541
8,553	F 00V C12 492	A1-23723/8553
8,565	F 00V C12 496	A1-23723/8565
8,571	F 00V C12 498	A1-23723/8571



## BOSCH

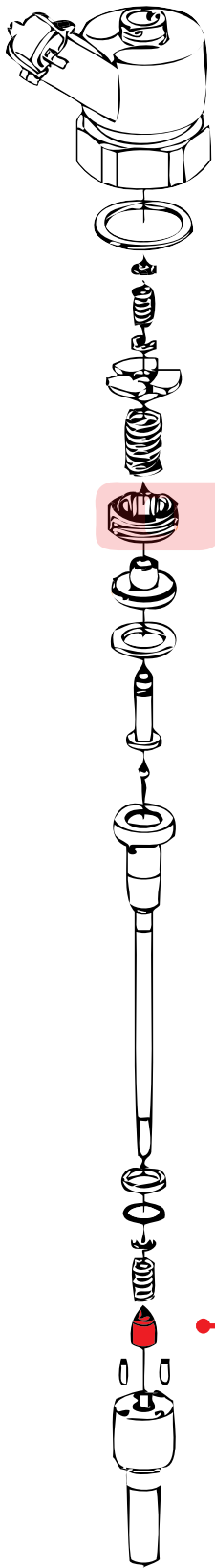

pin milled

**From 8,40 to 8,70**

Other sizes available upon request

根据要求提供其它尺寸

Code PERK	Dimintions	Increase	QTY
A1-23275	8,50 to 8,70	0,01	210



handbox 24 position

Code PERK	Dimintions	Increase	QTY
A1-23104	8,40 to 8,50	0,01	110



handbox 12 position

code individual thicknesses

dia	cod. PERK
8,40	A1-23104/840
8,41	A1-23104/841
8,42	A1-23104/842
8,43	A1-23104/843
8,44	A1-23104/844
8,45	A1-23104/845
8,46	A1-23104/846
8,47	A1-23104/847
8,48	A1-23104/848
8,49	A1-23104/849
8,50	A1-23104/850
8,51	A1-23104/851
8,52	A1-23104/852
8,53	A1-23104/853
8,54	A1-23104/854
8,55	A1-23104/855
8,56	A1-23104/856
8,57	A1-23104/857
8,58	A1-23104/858
8,59	A1-23104/859
8,60	A1-23104/860
8,61	A1-23104/861
8,62	A1-23104/862
8,63	A1-23104/863
8,64	A1-23104/864
8,65	A1-23104/865
8,66	A1-23104/866
8,67	A1-23104/867
8,68	A1-23104/868
8,69	A1-23104/869
8,70	A1-23104/870

Code PERK	Dimintions	Increase	QTY
A1-23298	8,40 to 8,70	0,01	310



handbox 36 position

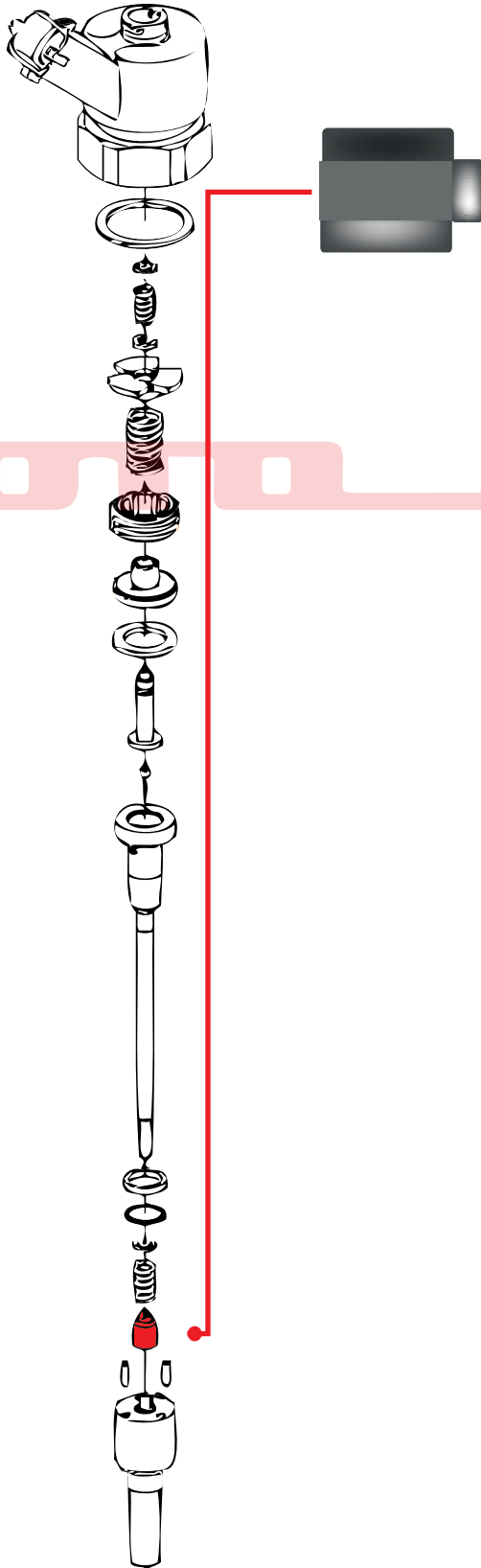

Code PERK	Dimintions	Increase	QTY
A1-23381	8,277 to 8,571	0,012	260



handbox 36 position

### Original Cross Reference

dia	ref. original	cod PERK
8,277	F 00V C12 300	A1-23104/8277
8,289	F 00V C12 304	A1-23104/8289
8,301	F 00V C12 308	A1-23104/8301
8,313	F 00V C12 312	A1-23104/8313
8,325	F 00V C12 316	A1-23104/8325
8,337	F 00V C12 320	A1-23104/8337
8,349	F 00V C12 324	A1-23104/8349
8,361	F 00V C12 328	A1-23104/8361
8,373	F 00V C12 332	A1-23104/8373
8,385	F 00V C12 336	A1-23104/8385
8,397	F 00V C12 340	A1-23104/8397
8,409	F 00V C12 344	A1-23104/8409
8,421	F 00V C12 348	A1-23104/8421
8,433	F 00V C12 352	A1-23104/8433
8,445	F 00V C12 356	A1-23104/8445
8,457	F 00V C12 360	A1-23104/8457
8,469	F 00V C12 364	A1-23104/8469
8,481	F 00V C12 368	A1-23104/8481
8,493	F 00V C12 372	A1-23104/8493
8,505	F 00V C12 376	A1-23104/8505
8,517	F 00V C12 380	A1-23104/8517
8,529	F 00V C12 384	A1-23104/8529
8,541	F 00V C12 388	A1-23104/8541
8,553	F 00V C12 392	A1-23104/8553
8,565	F 00V C12 396	A1-23104/8565
8,571	F 00V C12 398	A1-23104/ 8571

## BOSCH

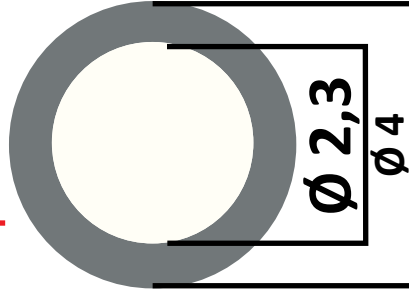
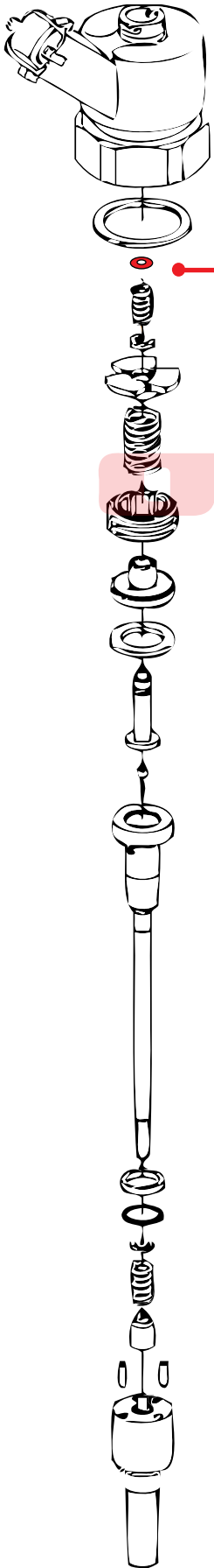

**From 1,20 to 1,90**

Other sizes available upon request

Code PERK	Dimintions	Increase	QTY
A1-23276	1,72 to 1,90	0,02	110



handbox 12 position

Code PERK	Dimintions	Increase	QTY
A1-23229	1,20 to 1,70	0,02	240



handbox 24 position

code individual thicknesss

dia	cod. PERK
1,20	A1-23229/120
1,22	A1-23229/122
1,24	A1-23229/124
1,26	A1-23229/126
1,28	A1-23229/128
1,30	A1-23229/130
1,32	A1-23229/132
1,34	A1-23229/134
1,36	A1-23229/136
1,38	A1-23229/138
1,40	A1-23229/140
1,42	A1-23229/142
1,44	A1-23229/144
1,46	A1-23229/146
1,48	A1-23229/148
1,50	A1-23229/150
1,52	A1-23229/152
1,54	A1-23229/154
1,56	A1-23229/156
1,58	A1-23229/158
1,60	A1-23229/160
1,62	A1-23229/162
1,64	A1-23229/164
1,66	A1-23229/166
1,68	A1-23229/168
1,70	A1-23229/170
1,72	A1-23229/172
1,74	A1-23229/174
1,76	A1-23229/176
1,78	A1-23229/178
1,80	A1-23229/180
1,82	A1-23229/182
1,84	A1-23229/184
1,86	A1-23229/186
1,88	A1-23229/188
1,90	A1-23229/190



## BOSCH

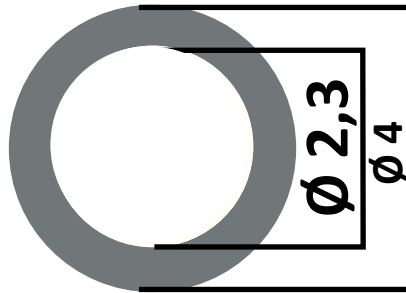
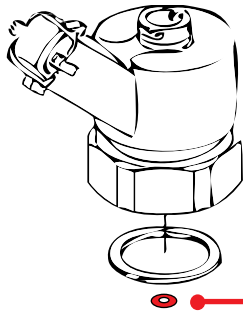

**From 1,20 to 1,90**

Other sizes available upon request

OTO PERK

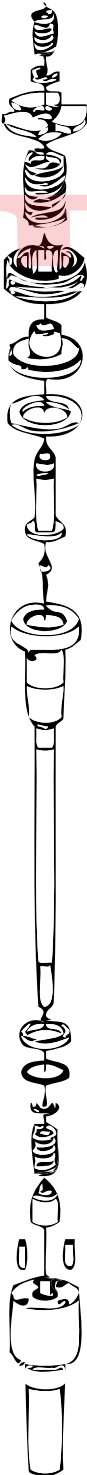

Code PERK	Dimentions	Increase	QTY
A1-23417	1,20 to 1,90	0,02	360



handbox 36 position

## BOSCH



From **1,20 to 1,96**

Other sizes available upon request

Code PERK	Dimintions	Increase	QTY
A1-23398	1,20 to 1,96	0,02	360



handbox 54 position

Code PERK	Dimintions	Increase	QTY
A1-23243	1,20 to 1,70	0,05	110



handbox 12 position

Code PERK	Dimintions	Increase	QTY
A1-23228	1,20 to 1,70	0,02	240
A1-23270	1,70 to 1,96	0,02	140



handbox 24 position

code individual thicknesses	
dia	cod. PERK
1,20	A1-23228/120
1,22	A1-23228/122
1,24	A1-23228/124
1,25	A1-23228/125
1,26	A1-23228/126
1,28	A1-23228/128
1,30	A1-23228/130
1,32	A1-23228/132
1,34	A1-23228/134
1,35	A1-23228/135
1,36	A1-23228/136
1,38	A1-23228/138
1,40	A1-23228/140
1,42	A1-23228/142
1,44	A1-23228/144
1,45	A1-23228/145
1,46	A1-23228/146
1,48	A1-23228/148
1,50	A1-23228/150
1,52	A1-23228/152
1,54	A1-23228/154
1,55	A1-23228/155
1,56	A1-23228/156
1,58	A1-23228/158
1,60	A1-23228/160
1,62	A1-23228/162
1,64	A1-23228/164
1,65	A1-23228/165
1,66	A1-23228/166
1,68	A1-23228/168
1,70	A1-23228/170
1,72	A1-23228/172
1,74	A1-23228/174
1,75	A1-23228/175
1,76	A1-23228/176
1,78	A1-23228/178
1,80	A1-23228/180
1,82	A1-23228/182
1,84	A1-23228/184
1,85	A1-23228/185
1,86	A1-23228/186
1,88	A1-23228/188
1,90	A1-23228/190
1,92	A1-23228/192
1,94	A1-23228/194
1,95	A1-23228/195
1,96	A1-23228/196



## BOSCH

www.eurodiesel.com

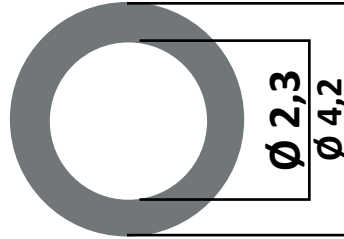
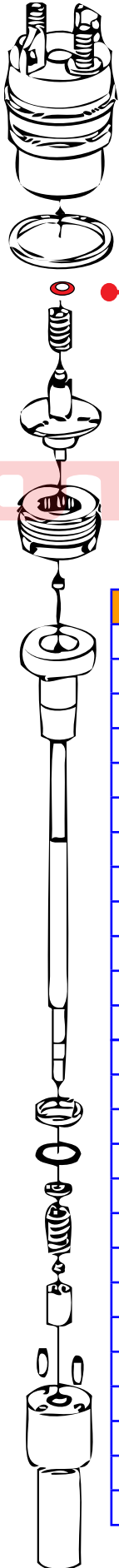

### Original Cross Reference

dia	ref. original	cod PERK	dia	ref. original	cod PERK
0,80	F 00R J00 481	A1-23228/80	1,32	F 00R J00 199	A1-23228/132
0,82	F 00R J00 482	A1-23228/82	1,34	F 00R J00 280	A1-23228/134
0,84	F 00R J00 483	A1-23228/84	1,36	F 00R J00 200	A1-23228/136
0,86	F 00R J00 484	A1-23228/86	1,38	F 00R J00 281	A1-23228/138
0,88	F 00R J00 485	A1-23228/88	1,40	F 00R J00 201	A1-23228/140
0,90	F 00R J00 486	A1-23228/90	1,42	F 00R J00 282	A1-23228/142
0,92	F 00R J00 189	A1-23228/92	1,44	F 00R J00 202	A1-23228/144
0,94	F 00R J00 207	A1-23228/94	1,46	F 00R J00 283	A1-23228/146
0,96	F 00R J00 190	A1-23228/96	1,48	F 00R J00 203	A1-23228/148
0,98	F 00R J00 271	A1-23228/98	1,50	F 00R J00 284	A1-23228/150
1,00	F 00R J00 191	A1-23228/100	1,52	F 00R J00 204	A1-23228/152
1,02	F 00R J00 272	A1-23228/102	1,54	F 00R J00 285	A1-23228/154
1,04	F 00R J00 192	A1-23228/104	1,56	F 00R J00 205	A1-23228/156
1,06	F 00R J00 273	A1-23228/106	1,58	F 00R J00 286	A1-23228/158
1,08	F 00R J00 193	A1-23228/108	1,60	F 00R J00 206	A1-23228/160
1,10	F 00R J00 274	A1-23228/110	1,62	F 00R J00 287	A1-23228/162
1,12	F 00R J00 194	A1-23228/112	1,64	F 00R J00 207	A1-23228/164
1,14	F 00R J00 275	A1-23228/114			
1,16	F 00R J00 195	A1-23228/116			
1,18	F 00R J00 276	A1-23228/118			
1,20	F 00R J00 196	A1-23228/120			
1,22	F 00R J00 277	A1-23228/122			
1,24	F 00R J00 197	A1-23228/124			
1,26	F 00R J00 278	A1-23228/126			
1,28	F 00R J00 198	A1-23228/128			
1,30	F 00R J00 279	A1-23228/130			

OTO PERK A.S 7419/12 Sokak No:22, 5. Site 35060 - Izmir / Turkiye

## BOSCH

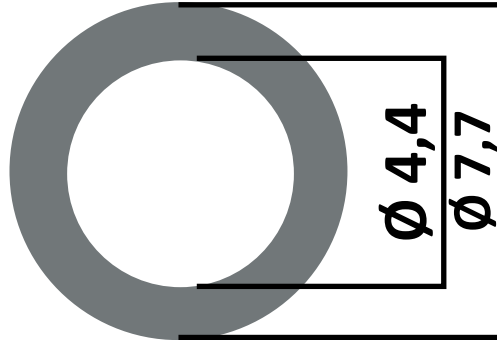
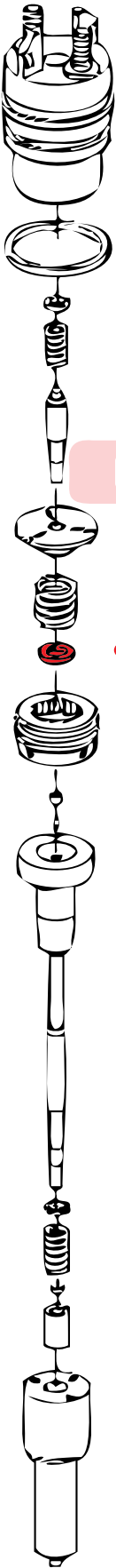

From **0,98** to **1,44**

Other sizes available upon request

Code PERK	Dimensions	Increase	QTY
A1-23332	0,98 to 1,44	0,02	240



handbox 24 position

code individual thicknesses

dia	cod. PERK
0,98	A1-23332/098
1,00	A1-23332/100
1,02	A1-23332/102
1,04	A1-23332/104
1,06	A1-23332/106
1,08	A1-23332/108
1,10	A1-23332/110
1,12	A1-23332/112
1,14	A1-23332/114
1,16	A1-23332/116
1,18	A1-23332/118
1,20	A1-23332/120
1,22	A1-23332/122
1,24	A1-23332/124
1,26	A1-23332/126
1,28	A1-23332/128
1,30	A1-23332/130
1,32	A1-23332/132
1,34	A1-23332/134
1,36	A1-23332/136
1,38	A1-23332/138
1,40	A1-23332/140
1,42	A1-23332/142
1,44	A1-23332/144

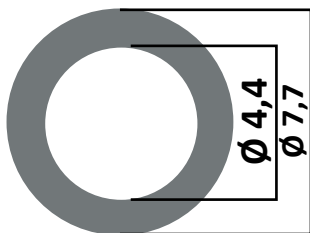
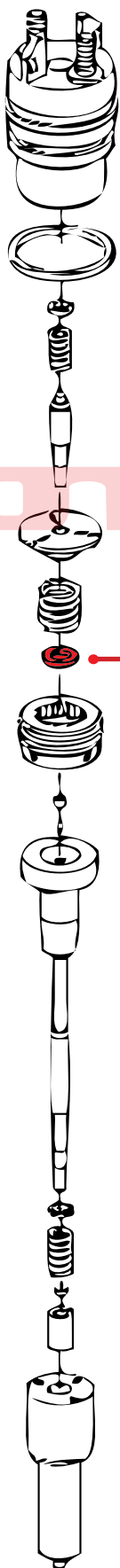

Code PERK	Dimintions	Increase	QTY
A1-23383	0,985 to 1,385	0,01	410



handbox 54 position

### Original Cross Reference

dia	ref. original	cod PERK
0,985	F 00R J01 008	A1-23332/0985
0,995	F 00R J01 009	A1-23332/0995
1,005	F 00R J01 010	A1-23332/1005
1,015	F 00R J01 011	A1-23332/1015
1,025	F 00R J01 012	A1-23332/1025
1,035	F 00R J01 013	A1-23332/1035
1,045	F 00R J01 014	A1-23332/1045
1,055	F 00R J01 015	A1-23332/1055
1,065	F 00R J01 016	A1-23332/1065
1,075	F 00R J01 017	A1-23332/1075
1,085	F 00R J01 018	A1-23332/1085
1,095	F 00R J01 019	A1-23332/1095
1,105	F 00R J01 020	A1-23332/1105
1,115	F 00R J01 021	A1-23332/1115
1,125	F 00R J01 022	A1-23332/1125
1,135	F 00R J01 023	A1-23332/1135
1,145	F 00R J01 024	A1-23332/1145
1,155		A1-23332/1155
1,165		A1-23332/1165
1,175		A1-23332/1175
1,185		A1-23332/1185
1,195		A1-23332/1195
1,205		A1-23332/1205
1,215		A1-23332/1215
1,225		A1-23332/1225
1,235		A1-23332/1235
1,245		A1-23332/1245
1,255		A1-23332/1255
1,265		A1-23332/1265
1,275		A1-23332/1275
1,285		A1-23332/1285
1,295		A1-23332/1295
1,305		A1-23332/1305
1,315		A1-23332/1315
1,325		A1-23332/1325
1,335		A1-23332/1335
1,345		A1-23332/1345
1,355		A1-23332/1355
1,365		A1-23332/1365
1,375		A1-23332/1375
1,385		A1-23332/1385

## BOSCH

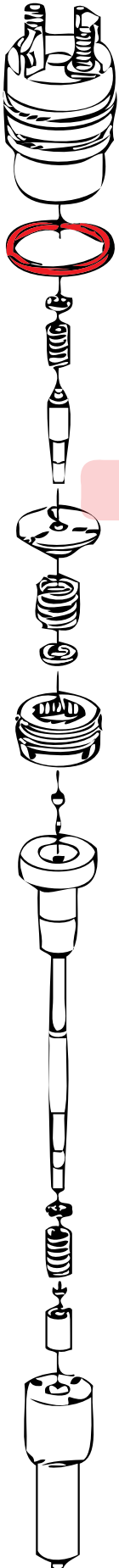

**From 1,34 to 1,76**

Other sizes available upon request

Code PERK	Dimintions	Increase	QTY
A1-23287	1,34 to 1,76	0,02	220



handbox 24 position

code individual thicknesses

dia	cod. PERK
1,34	A1-23287/136
1,36	A1-23287/138
1,38	A1-23287/140
1,40	A1-23287/142
1,42	A1-23287/144
1,44	A1-23287/146
1,46	A1-23287/148
1,48	A1-23287/150
1,50	A1-23287/152
1,52	A1-23287/154
1,54	A1-23287/156
1,56	A1-23287/158
1,58	A1-23287/160
1,60	A1-23287/162
1,62	A1-23287/164
1,64	A1-23287/166
1,66	A1-23287/168
1,68	A1-23287/170
1,70	A1-23287/172
1,72	A1-23287/174
1,74	A1-23287/176
1,76	A1-23287/178

## BOSCH

www.eurodiesel.com

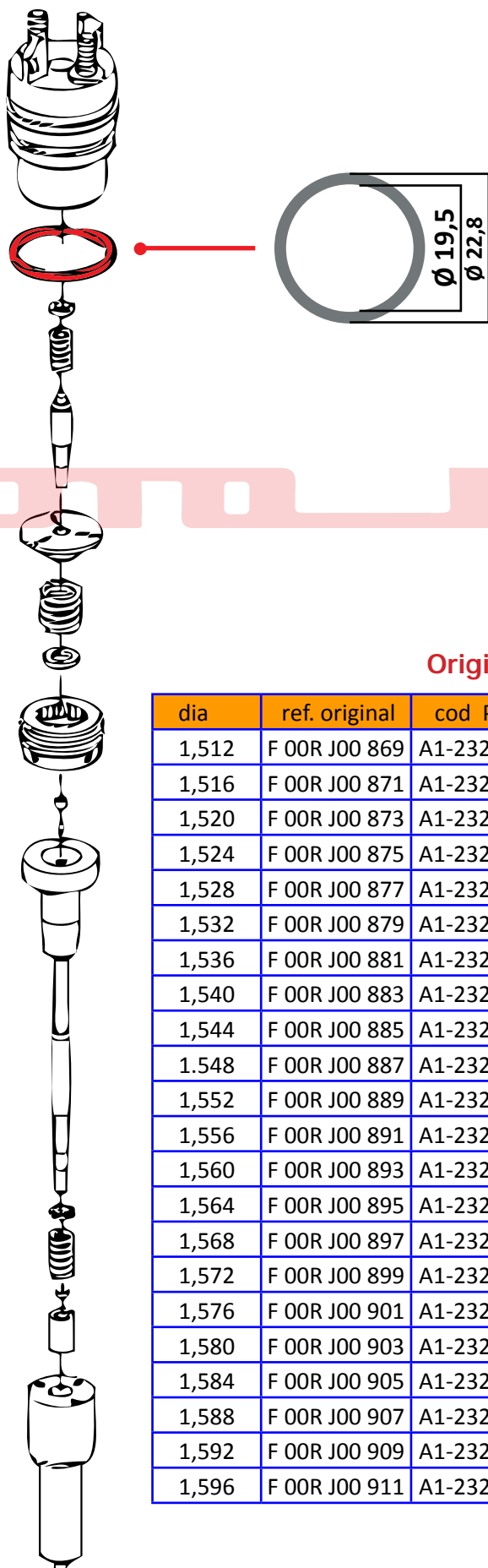

Code PERK	Dimintions	Increase	QTY
A1-23385	1,512 to 1,684	0,004	440



handbag 54 position

### Original Cross Reference

dia	ref. original	cod PERK
1,512	F 00R J00 869	A1-23287/1512
1,516	F 00R J00 871	A1-23287/1516
1,520	F 00R J00 873	A1-23287/1520
1,524	F 00R J00 875	A1-23287/1524
1,528	F 00R J00 877	A1-23287/1528
1,532	F 00R J00 879	A1-23287/1532
1,536	F 00R J00 881	A1-23287/1536
1,540	F 00R J00 883	A1-23287/1540
1,544	F 00R J00 885	A1-23287/1544
1,548	F 00R J00 887	A1-23287/1548
1,552	F 00R J00 889	A1-23287/1552
1,556	F 00R J00 891	A1-23287/1556
1,560	F 00R J00 893	A1-23287/1560
1,564	F 00R J00 895	A1-23287/1564
1,568	F 00R J00 897	A1-23287/1568
1,572	F 00R J00 899	A1-23287/1572
1,576	F 00R J00 901	A1-23287/1576
1,580	F 00R J00 903	A1-23287/1580
1,584	F 00R J00 905	A1-23287/1584
1,588	F 00R J00 907	A1-23287/1588
1,592	F 00R J00 909	A1-23287/1592
1,596	F 00R J00 911	A1-23287/1596

dia	ref. original	cod PERK
1,600	F 00R J00 913	A1-23287/1600
1,604	F 00R J00 915	A1-23287/1604
1,608	F 00R J00 917	A1-23287/1608
1,612	F 00R J00 919	A1-23287/1612
1,616	F 00R J00 921	A1-23287/1616
1,620	F 00R J00 923	A1-23287/1620
1,624	F 00R J00 925	A1-23287/1624
1,628	F 00R J00 927	A1-23287/1628
1,632	F 00R J00 929	A1-23287/1632
1,636	F 00R J00 931	A1-23287/1636
1,640	F 00R J00 933	A1-23287/1640
1,644	F 00R J00 935	A1-23287/1644
1,648	F 00R J00 937	A1-23287/1648
1,652	F 00R J00 939	A1-23287/1652
1,656	F 00R J00 941	A1-23287/1656
1,660	F 00R J00 943	A1-23287/1660
1,664	F 00R J00 945	A1-23287/1664
1,668	F 00R J00 947	A1-23287/1668
1,672	F 00R J00 949	A1-23287/1672
1,676	F 00R J00 951	A1-23287/1676
1,680	F 00R J00 953	A1-23287/1680
1,684	F 00R J00 955	A1-23287/1684

OTO PERK A.S 7419/12 Sokak No:22, 5. Site 35060 - Izmir / Turkiye



## BOSCH

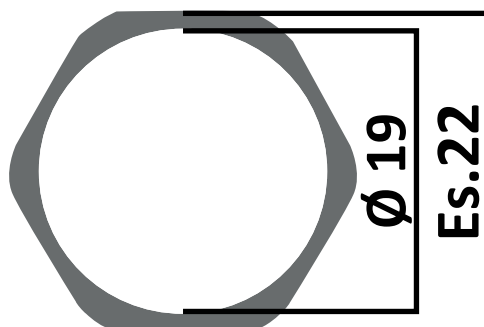
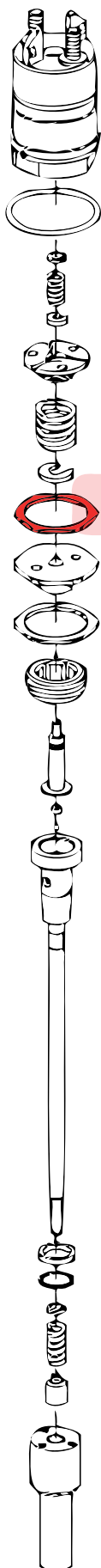

From **0,90** to **1,40**

Other sizes available upon request

Code PERK	Dimintions	Increase	QTY
A1-23273	0,90 to 1,00	0,01	110
A1-23235	1,00 to 1,10	0,01	110
A1-23301	1,30 to 1,40	0,01	110



handbox12 position

Code PERK	Dimintions	Increase	QTY
A1-23386	0,90 to 1,40	0,01	510



handbox 54 position

code individual thicknesses	
dia	cod. PERK
0,90	A1-23235/090
0,91	A1-23235/091
0,92	A1-23235/092
0,93	A1-23235/093
0,94	A1-23235/094
0,95	A1-23235/095
0,96	A1-23235/096
0,97	A1-23235/097
0,98	A1-23235/098
0,99	A1-23235/099
1,00	A1-23235/100
1,01	A1-23235/101
1,02	A1-23235/102
1,03	A1-23235/103
1,04	A1-23235/104
1,05	A1-23235/105
1,06	A1-23235/106
1,07	A1-23235/107
1,08	A1-23235/108
1,09	A1-23235/109
1,10	A1-23235/110
1,11	A1-23235/111
1,12	A1-23235/112
1,13	A1-23235/113
1,14	A1-23235/114
1,15	A1-23235/115
1,16	A1-23235/116
1,17	A1-23235/117
1,18	A1-23235/118
1,19	A1-23235/119
1,20	A1-23235/120
1,21	A1-23235/121
1,22	A1-23235/122
1,23	A1-23235/123
1,24	A1-23235/124
1,25	A1-23235/125
1,26	A1-23235/126
1,27	A1-23235/127
1,28	A1-23235/128
1,29	A1-23235/129
1,30	A1-23235/130
1,31	A1-23235/131
1,32	A1-23235/132
1,33	A1-23235/133
1,34	A1-23235/134
1,35	A1-23235/135
1,36	A1-23235/136
1,37	A1-23235/137
1,38	A1-23235/138
1,39	A1-23235/139
1,40	A1-23235/140

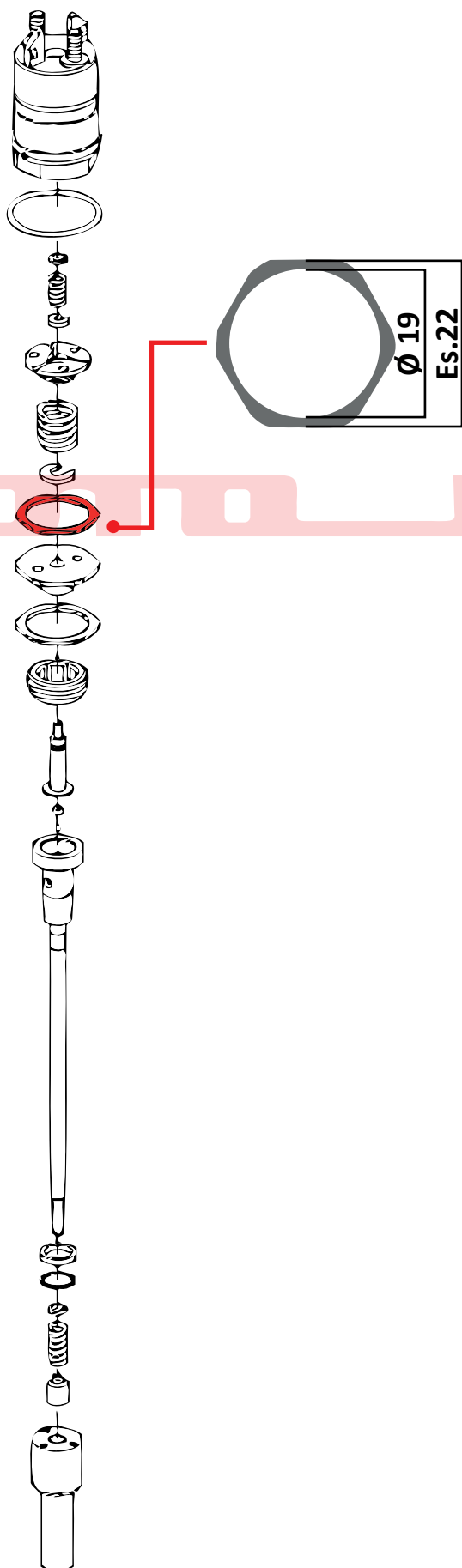

### Original Cross Reference

dia	ref. original	cod PERK
1,21	F 00R J00 120	A1-23235/121
1,22	F 00R J00 122	A1-23235/122
1,23	F 00R J00 124	A1-23235/123
1,24	F 00R J00 126	A1-23235/124
1,25	F 00R J00 128	A1-23235/125
1,26	F 00R J00 130	A1-23235/126
1,27	F 00R J00 132	A1-23235/127
1,28	F 00R J00 134	A1-23235/128
1,29	F 00R J00 136	A1-23235/129
1,30	F 00R J00 138	A1-23235/130
1,31	F 00R J00 140	A1-23235/131
1,32	F 00R J00 142	A1-23235/132
1,33	F 00R J00 144	A1-23235/133
1,34	F 00R J00 146	A1-23235/134
1,35	F 00R J00 148	A1-23235/135
1,36	F 00R J00 150	A1-23235/136
1,37	F 00R J00 152	A1-23235/137
1,38	F 00R J00 154	A1-23235/138

## BOSCH

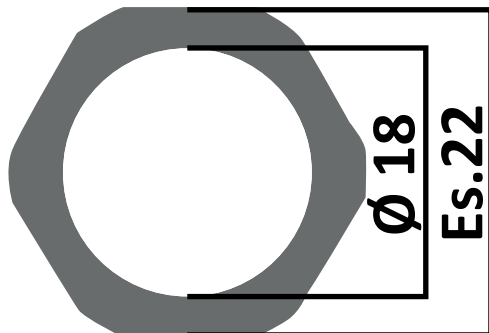
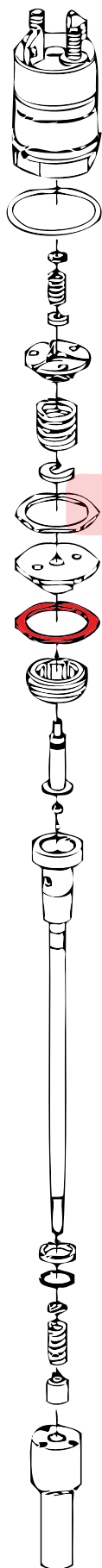

From **0,90 to 1,12**

Other sizes available upon request

Code PERK	Dimintions	Increase	QTY
A1-23325	0,90 to 1,00	0,01	110
A1-23288	1,00 to1,10	0,01	110



handbox 12 position

Code PERK	Dimintions	Increase	QTY
A1-23397	0,90 to 1,12	0,01	230



handbox 24 position

code individual thickness

dia	cod. PERK
0,90	A1-23288/090
0,91	A1-23288/091
0,92	A1-23288/092
0,93	A1-23288/093
0,94	A1-23288/094
0,95	A1-23288/095
0,96	A1-23288/096
0,97	A1-23288/097
0,98	A1-23288/098
0,99	A1-23288/099
1,00	A1-23288/100
1,01	A1-23288/101
1,02	11-23288/102
1,03	11-23288/103
1,04	11-23288/104
1,05	11-23288/105
1,06	11-23288/106
1,07	11-23288/107
1,08	11-23288/108
1,09	11-23288/109
1,10	11-23288/110
1,11	11-23288/111
1,12	11-23288/112

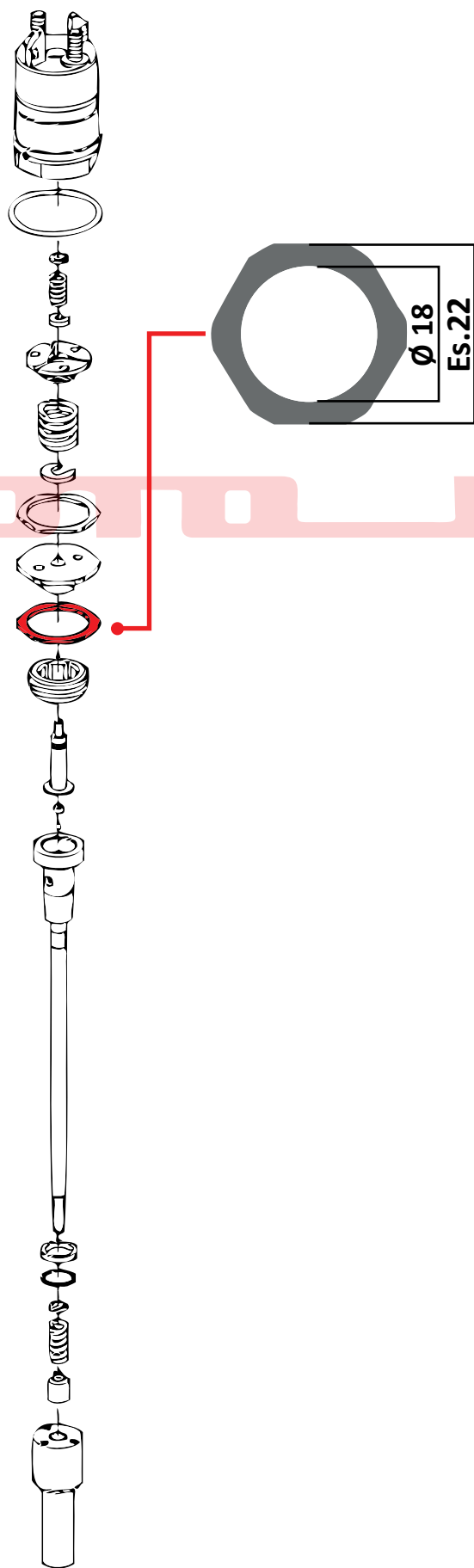

Code PERK	Dimintions	Increase	QTY
A1-23388	0,950 to 1,054	0,004	270



handbox 36 position

### Original Cross Reference

dia	ref. original	cod PERK
0,950	F 00R J00 024	A1-23288/0950
0,954	F 00R J00 026	A1-23288/0954
0,958	F 00R J00 028	A1-23288/0958
0,962	F 00R J00 030	A1-23288/0962
0,966	F 00R J00 032	A1-23288/0966
0,970	F 00R J00 034	A1-23288/0970
0,974	F 00R J00 036	A1-23288/0974
0,978	F 00R J00 038	A1-23288/0978
0,982	F 00R J00 040	A1-23288/0982
0,986	F 00R J00 042	A1-23288/0986
0,990	F 00R J00 044	A1-23288/0990
0,994	F 00R J00 046	A1-23288/0994
0,998	F 00R J00 048	A1-23288/0998
1,002	F 00R J00 050	A1-23288/1002
1,006	F 00R J00 052	A1-23288/1006
1,010	F 00R J00 054	A1-23288/1010
1,014	F 00R J00 056	A1-23288/1014
1,018	F 00R J00 058	A1-23288/1018
1,022	F 00R J00 060	A1-23288/1022
1,026	F 00R J00 062	A1-23288/1026
1,030	F 00R J00 064	A1-23288/1030
1,034	F 00R J00 066	A1-23288/1034
1,038	F 00R J00 068	A1-23288/1038
1,042	F 00R J00 070	A1-23288/1042
1,046	F 00R J00 072	A1-23288/1046
1,050	F 00R J00 074	A1-23288/1050
1,054	F 00R J00 076	A1-23288/1054

## BOSCH

### Original No Cross Reference

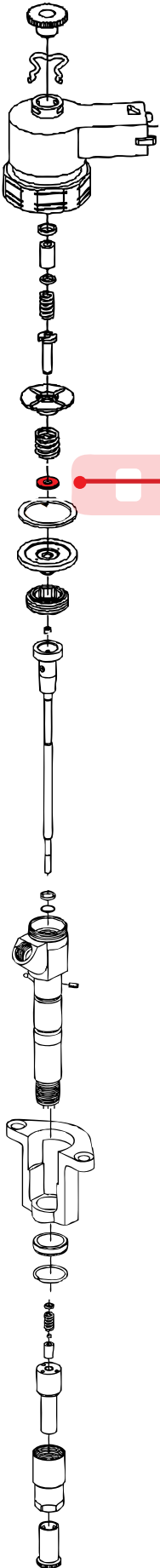

From **0,78..to 1,25**

Other sizes available upon request

Code PERK	Dimensions	Increase	QTY
A1-23389	0,78 to 1,25	0,01	480



handbox 54 position

dia	ref. original	cod PERK
0,78		A1-23389/078
0,79		A1-23389/079
0,80		A1-23389/080
0,81		A1-23389/081
0,82	F 00R J01 347	A1-23389/820
0,83	F 00R J01 349	A1-23389/830
0,84	F 00R J01 351	A1-23389/840
0,85	F 00R J01 353	A1-23389/850
0,86	F 00R J01 355	A1-23389/860
0,87	F 00R J01 357	A1-23389/870
0,88	F 00R J01 359	A1-23389/880
0,89	F 00R J01 361	A1-23389/890
0,90	F 00R J01 363	A1-23389/900
0,91	F 00R J01 365	A1-23389/901
0,92	F 00R J01 367	A1-23389/920
0,93	F 00R J01 369	A1-23389/930
0,94	F 00R J01 371	A1-23389/940
0,95	F 00R J01 373	A1-23389/950
0,96	F 00R J01 375	A1-23389/960
0,97	F 00R J01 377	A1-23389/970
0,98	F 00R J01 379	A1-23389/980
0,99	F 00R J01 381	A1-23389/990
1,00	F 00R J01 383	A1-23389/1000
1,01	F 00R J01 385	A1-23389/1010
1,02	F 00R J01 387	A1-23389/1020
1,03	F 00R J01 389	A1-23389/1030
1,04	F 00R J01 391	A1-23389/1040
1,05	F 00R J01 393	A1-23389/1050
1,06	F 00R J01 395	A1-23389/1060
1,07	F 00R J01 397	A1-23389/1070
1,08	F 00R J01 399	A1-23389/1080
1,09	F 00R J01 401	A1-23389/1090
1,10	F 00R J01 403	A1-23389/1100
1,11	F 00R J01 405	A1-23389/1110
1,12	F 00R J01 407	A1-23389/1120
1,13	F 00R J01 409	A1-23389/1130
1,14	F 00R J01 411	A1-23389/1140
1,15	F 00R J01 413	A1-23389/1150
1,16	F 00R J01 415	A1-2389/1160
1,17	F 00R J01 417	A1-23389/1170
1,18	F 00R J01 419	A1-23389/1180
1,19		A1-23389/1190
1,20		A1-23389/1200
1,21		A1-23389/121
1,22		A1-23389/122
1,23		A1-23389/123
1,24		A1-23389/124
1,25		A1-23389/125



## BOSCH

www.eurodiesel.com



**From 1,20 to 1,90**

Other sizes available upon request

根据要求提供其它尺寸

OTO PERK A.S 7419/12 Sokak No:22, 5. Site 35060 - Izmir / Turkiye

Code PERK	Dimintions	Increase	QTY
A1-23272	1,72 to 1,90	0,02	100

handbox 12 position

Code PERK	Dimintions	Increase	QTY
A1-23231	1,20 to 1,70	0,02	240

handbox 24 position

code individual thicknesses

dia	cod. PERK
1,20	A1-23231/120
1,22	A1-23231/122
1,24	A1-23231/124
1,26	A1-23231/126
1,28	A1-23231/128
1,30	A1-23231/130
1,32	A1-23231/132
1,34	A1-23231/134
1,36	A1-23231/136
1,38	A1-23231/138
1,40	A1-23231/140
1,42	A1-23231/142
1,44	A1-23231/144
1,46	A1-23231/146
1,48	A1-23231/148
1,50	A1-23231/150
1,52	A1-23231/152
1,54	A1-23231/154
1,56	A1-23231/156
1,58	A1-23231/158
1,60	A1-23231/160
1,62	A1-23231/162
1,64	A1-23231/164
1,66	A1-23231/166
1,68	A1-23231/168
1,70	A1-23231/170
1,72	A1-23231/172
1,74	A1-23231/174
1,76	A1-23231/176
1,78	A1-23231/178
1,80	A1-23231/180
1,82	A1-23231/182
1,84	A1-23231/184
1,86	A1-23231/186
1,88	A1-23231/188
1,90	A1-23231/190

## BOSCH

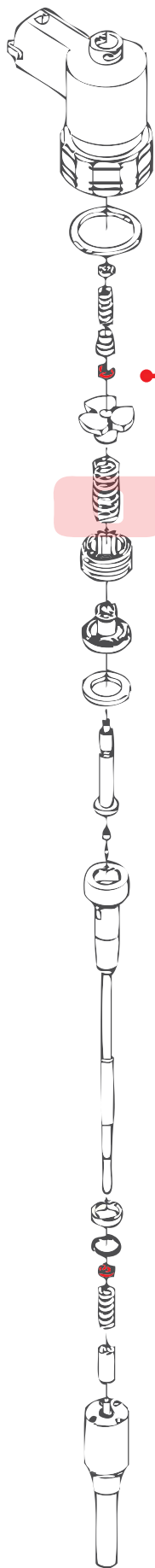

From **1,155...to 1,265**

Other sizes available upon request

OTO PERK

Code PERK	Dimensions	Increase	QTY
A1-23396	1,155 to 1,265	0,01	120



handbox 12 position

### Original No Cross Reference

dia	ref. original	cod.PERK
1,155	F 00V C18 300	A1-23396/1155
1,165	F 00V C18 302	A1-23396/1165
1,175	F 00V C18 304	A1-23396/1175
1,185	F 00V C18 306	A1-23396/1185
1,195	F 00V C18 308	A1-23396/1195
1,205	F 00V C18 310	A1-23396/1205
1,215	F 00V C18 312	A1-23396/1215
1,225	F 00V C18 314	A1-23396/1225
1,235	F 00V C18 316	A1-23396/1235
1,245	F 00V C18 318	A1-23396/1245
1,255	F 00V C18 320	A1-23396/1255
1,265	F 00V C18 322	A1-23396/1265